

KIRKLAND

FINE ARTS CENTER



Technical Information

Kirkland Fine Arts Center
Millikin University
1184 West Main Street
Decatur, IL 62522-2084

Table of Contents

Stage Information:

- 5. Stage Floor Plan with Measurements
- 6. North Section View of Theatre
- 7. Loading and Stage Information
 - Loading
 - Stage
- 8. Orchestra Pit/Lift
 - Orchestra Shell and Ceiling
 - Musical Equipment
- 9. Risers
 - Marley Dance Floor
 - Ladders
- 10. Fly System
 - Act Curtain
 - Other House Soft Goods
- 11. Fly Line Sets

Lighting System:

- 13. House Board
 - Dimmers
 - Circuiting
 - Company Switch
- 14. Lighting Equipment
 - Other Lighting Equipment

Sound System:

- 16. Main Speakers
 - House Mixer
 - Playback & Recording Equipment
 - Monitor Systems
- 17. Paging System
 - Wireless System
 - Sound Circuiting
- 18. Microphones
 - Sound Accessories
- 19. Theatre Communications
 - Supplemental P.A.
 - Company Switch
- 20. Speaker System Diagram

General Auditorium Information:

- 22. Auditorium Seating Plan (Main Floor and Balcony)
- 23. Kirkland Main Level Ground Plan
- 24. Kirkland Lower Level Ground Plan
- 25. Dressing Rooms, Green Room, and Backstage
 - Use of Spaces
 - Campus Security
 - Special Effects
- 26. Theatrical Suppliers
- 27. Medical Emergency Contact Information

Traveling Information:

- 29. Map—Illinois Reference with Major Highways
- 30. Map—Champaign/Urbana to Decatur
 - Springfield to Decatur
- 31. Map—Bloomington/Normal to Decatur Transportation
- 32. Map—Decatur Area
- 33. Map—Millikin University Campus
- 34. Decatur Area Lodging Information
- 35. Decatur Area Dining Information

Kirkland Fine Arts Center

Millikin University
1184 West Main Street
Decatur, IL 62522-2084

(217) 424-6253
kfac@millikin.edu

Director of Kirkland Fine Arts Center:

Bryan Diver
bdiver@millikin.edu
(217) 424-3925

Patron Relations and Marketing Manager:

Kate Lacy
kllacy@millikin.edu
(217) 424-6318

Production Manager:

Danielle Curtis
dacurtis@millikin.edu
(217) 424-6341

Sound and Stage Supervisor

@millikin.edu
(217) 424-6224

House Capacity:

Orchestra Level	1428
Balcony	475
Total	1903

Public Accommodations:

Eight Wheelchair Accessible Spaces
Eight Assistive Listening Devices available from the Ticket Office

Business Hours: Monday-Friday 8:00am-4:30pm Central Standard Time

Box Office Hours: Tuesday- Friday noon-4:30p.m. Central Standard Time

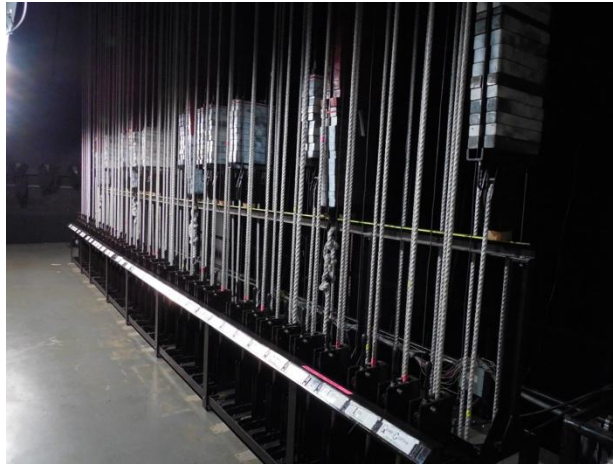

Stage Information

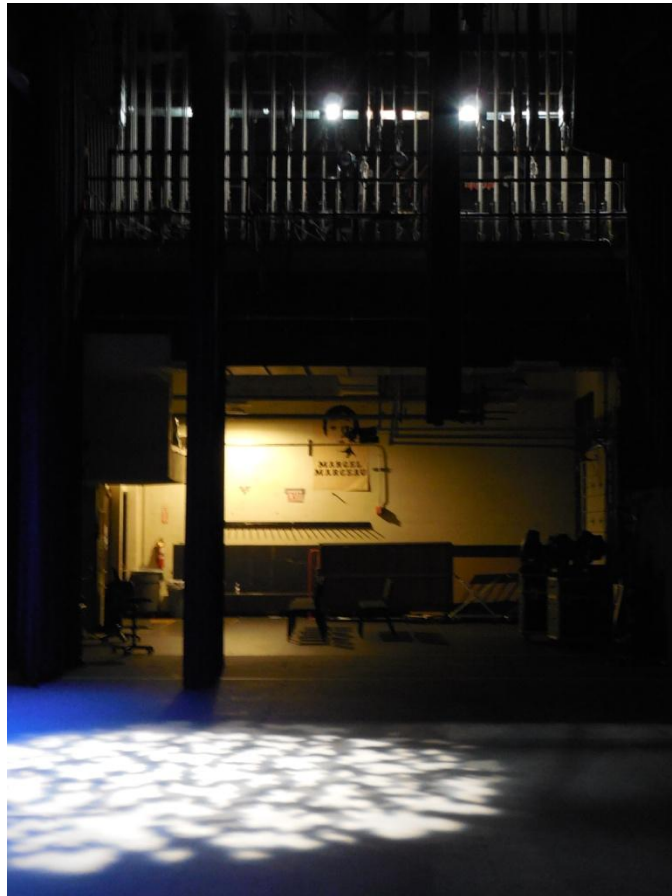

Stage Floor Plan with Measurements

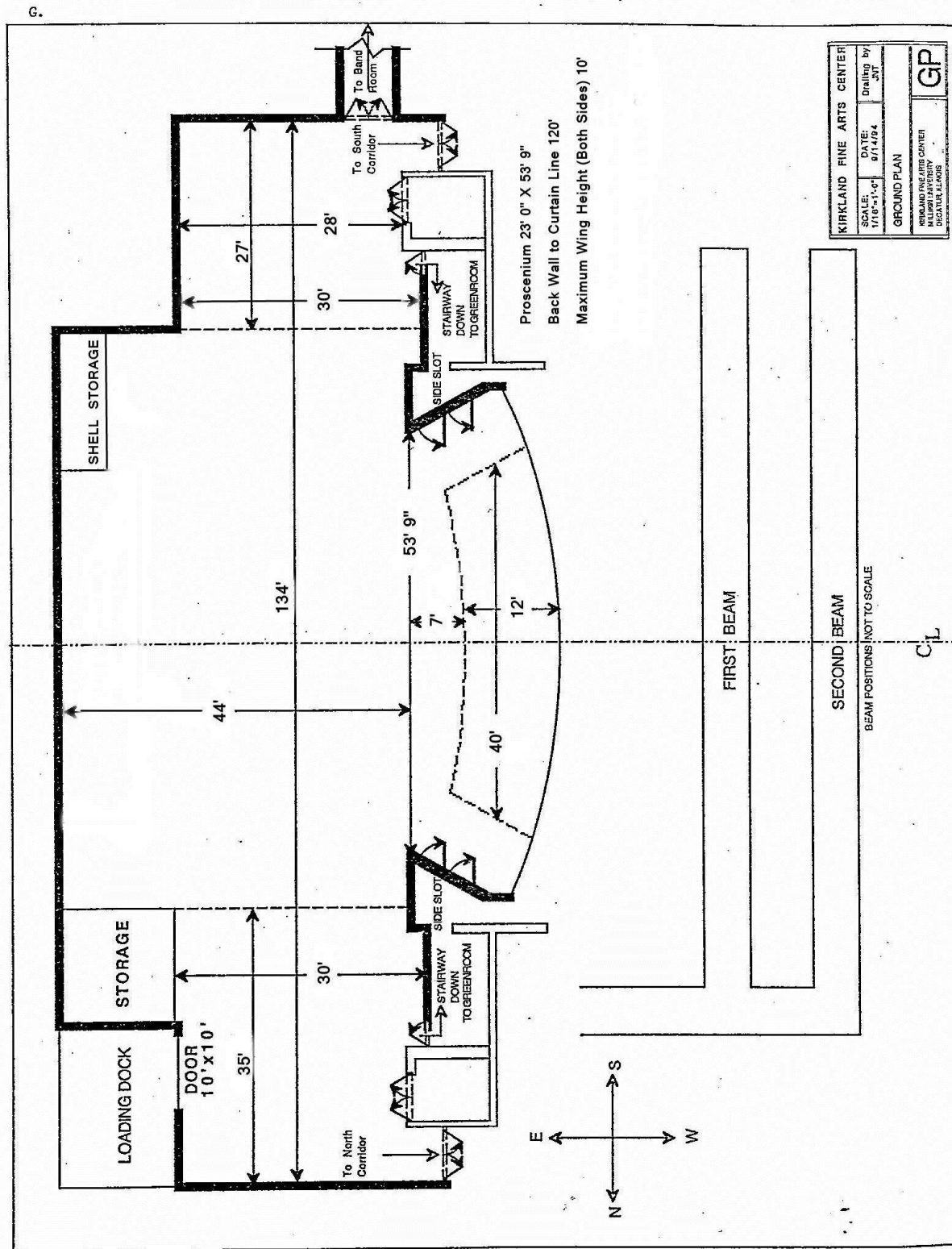

North Section View of Theatre

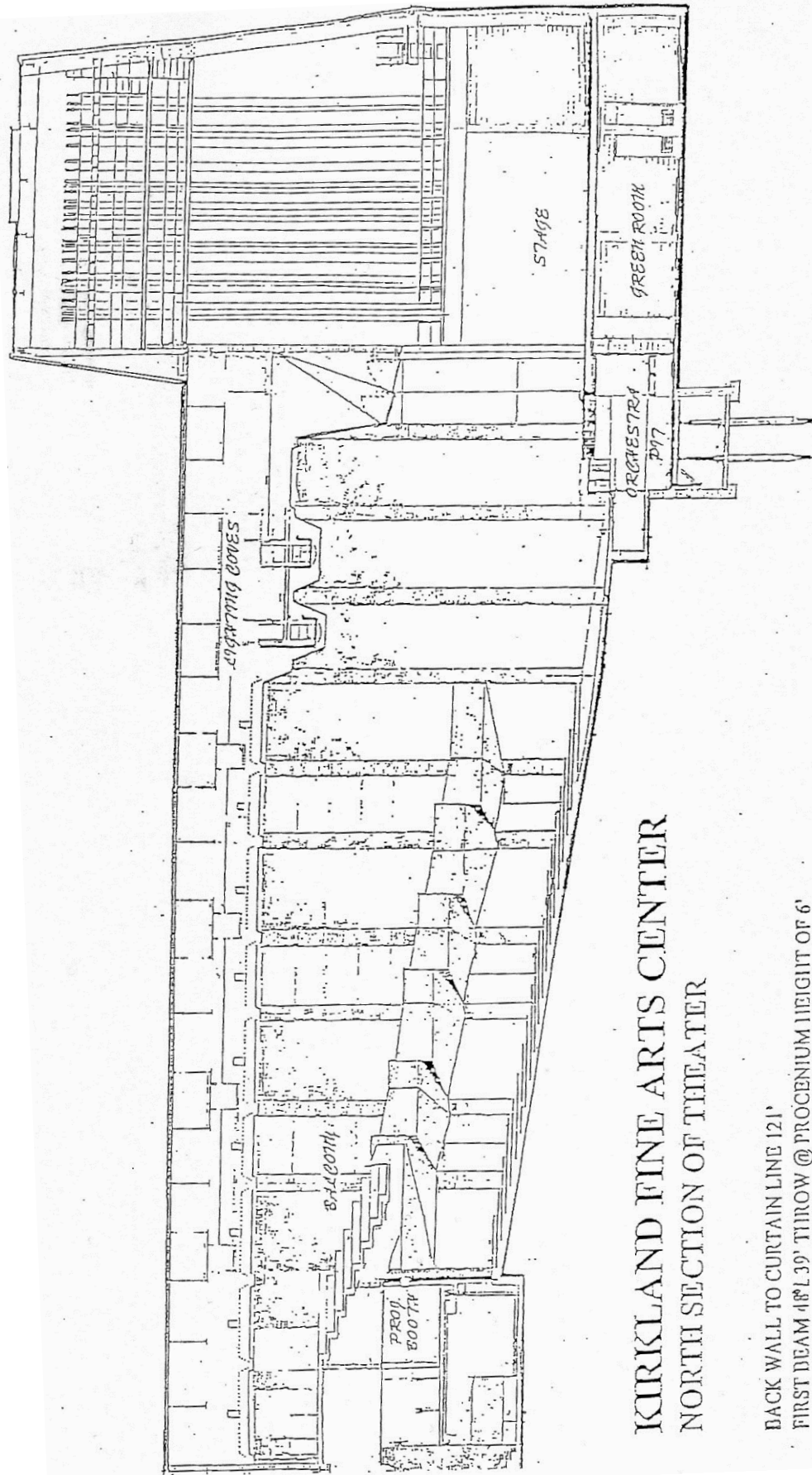

KIRKLAND FINE ARTS CENTER NORTH SECTION OF THEATER

BACK WALL TO CURTAIN LINE 121'
FIRST BEAM 48' L 39' THROW @ PROCENIUM HEIGHT OF 6'
SECOND BEAM 40' L 46' THROW @ PROCENIUM HEIGHT OF 6'

Orchestra Pit/Lift

Kirkland Fine Arts Center Production Manager (PM), Lighting and Sound Supervisor (LSS), Stage Managers (SM's), and Assistant Stage Managers (ASM's) are the only ones allowed to raise and lower the pit.

No one is allowed to ride the pit other than the controller and any crewmember holding equipment. No performance can occur on a moving pit. Pit doors remain locked until the pit is locked down and declared safe by the above listed employees. No one is allowed to open doors to the pit to allow pit access to others.

Width—40'
Depth—12'

Located downstage of the apron:

Weight Capacity: 100-lbs/sq. foot (24 ton maximum)

Control is located on the stage right wall, or with removable remote control downstage center.

The pit is on a hydraulic lift with four preset levels. The pit can also be stopped at any position using the stop button.

Preset Levels:	4—Stage Level	0'0"
	3—House Level	3'6"
	2—Pit Level	8'0"
	1—Green Room	11'0"

Single access doors are located on Preset Level 2 (Pit Level) on stage right and stage left.

Double access doors are located on Preset Level 1 (Green Room) center stage.

Orchestra Shell and Choral Shell

The “Diva” orchestra shell has four different arrangements combining ten walls and four 8” ceiling panels permanently hung over the stage. 26 Source Four par lighting instruments are mounted into the ceiling.

Dimensions: Depth—34'10"
 Width—53'9"
 Height—23'

Musical Equipment

Pianos: 3—Steinway 9' Grand Pianos. Excellent condition. Located on stage.
1—Baldwin 9' Grand Piano. Good condition. Located in the lobby.
1—Austin Pipe Organ (Opus #2519). Good condition. Located at pit level. Pipes in house.

Stands: 100—Black Music Stands

Music Stand Lights: 36 available

Piano Stand Lights: 4 available

Orchestra Chairs: 78 available

Cello Chairs: 12 available

Podiums: 1 Step and 2 Step available

Instruments: Yamaha Stage Custom Advantage Split Lugs 5-Piece Drum Set
2 Fender Stratocaster 6-String Guitars
1 Fender 4 String Bass
1 Rossetti 3460 Piano Accordion

Amplifiers: 2-Fender '65 Twin Reverb Guitar Amplifier
SWR Workingman's 4004, 4 x 10T & 1 x 15T Package Amplifier

Risers

Wenger Versalites 4' * 8': 24 available

Possible Deck Elevations: 8—8" Height
8—16" Height
8—24" Height
8—32" Height
8—40" Height
4—48" Height
6—24"-40" Height (telescoping legs)
36—8' braces

Corner Pieces: Triangles—6" Height
Trapezoids—16" Height
Pentagons—24" Height

Corner pieces can be used to assemble semi-circle seating of 125 people.

Marley Dance Floor

The Marley dance floor is reversible with black on one side and gray on the other. Each floor section is 5'3" wide and 60' long. No scenery may be placed on the floor without the consent of the Production Manager. The Marley Dance floor does not extend to cover the pit area.

Ladders

Fiberglass Standing Ladders: 2—6' Height
2—10' Height
1—16' Height

Genie Lifts: 1—PLI24/DC 12v (Max Height 24 feet)

Fly System

The fly system is a double purchase with locks and roped with ¾ (3) strand premium manila. Battens are rigged to be loaded at 4' above the stage floor.

Grid Height—63'11"

Maximum Batten Height—61'11"

Control Rail Height—17'10"

Loading Rail Height—51'0"

Pipe Length—60'0"

Outside Pipe Diameter—0'2"

Arbor Length—10'6"

36—Moveable lines.

26—Clearable lines (maximum).

Pipes cannot be extended. When the stage wings are masked properly, the stage opening is reduced to a max. of 40'

Act curtain, Midstage curtains, and Upstage curtains (lines 1, 17, 34 respectively) cannot be cleared.

Acoustical Ceiling (lines 6, 15, 24, 33) cannot be cleared.

Line set 5 is currently inoperable

Act Curtain

The Kirkland Fine Arts Center Act Curtain is a heavy lined rose red velour measuring 30' x 60'. The curtain can be operated manually as either a traveler from stage right to left or as a guillotine from the control rail. The act curtain is usually guillotined and doubles as a front border. Maximum traveled opening is 40'.

Other House Soft Goods

All masking drapes are black IFR (Inherently Fire Retardant) poly.

Borders: 4—10' x 60'

Legs: 1 pair—10' x 30'

1 pair—16' x 30'

3 pair—17' x 30'

Travelers: 2—30' x 60' (Pleats sewn in)

Cyclorama: 1—30' x 60' (Opera Creamy White Front/Rear Projection Screen)

Scrim: 1—30' x 60' (White)

1—30' x 60' (Black)

Because of catwalks at the sides of the stage, it is easy to breast non-working lines upstage or downstage in either direction.

Fly Line Sets

Set#	Location	Standard	Notes
	0' 0"	Proscenium Wall	
	0' 6"	Fire Wall	
1.	1' 9"	Act Curtain	NOT CLEARABLE
2.	2' 8"	First Leg	
3.	3' 7"	First Electric	48 Circuits
4.	5' 0"	Batten	
5.	5' 6"	Batten	INOPERABLE
6.	6' 4"	First Ceiling	NOT CLEARABLE
7.	7' 0"	Batten	
8.	7' 10"	First Border	
9.	8' 6"	Second Leg	
10.	9' 6"	Second Electric	20 Circuits
11.	10' 6"	Batten	
12.	11' 6"	Batten	
13.	12' 6"	Batten	
14.	13' 0"	Batten	
15.	14' 3"	Second Ceiling	NOT CLEARABLE
16.	15' 0"	Batten	
17.	15' 9"	Midstage Curtain	NOT CLEARABLE
18.	16' 6"	Midstage Border	
19.	17' 6"	Third Leg	
20.	18' 6"	Third Electric	20 Circuits
21.	19' 6"	Batten	
22.	20' 6"	Batten	
23.	21' 6"	Batten	
24.	22' 2"	Third Ceiling	NOT CLEARABLE
25.	23' 0"	Batten	
26.	23' 6"	Batten	
27.	24' 6"	Border	
28.	25' 6"	Fourth Leg	
29.	26' 6"	Fourth Electric	20 Circuits
30.	27' 6"	Batten - Scrim	
31.	28' 6"	Fifth Electrical	16 Circuits
32.	29' 6"	Batten	
33.	30' 1"	Fourth Ceiling	NOT CLEARABLE
34.	31' 0"	Upstage Curtain	NOT CLEARABLE
35.	32' 0"	Batten	
36.	33' 0"	Batten – Cyclorama	NOT CLEARABLE

Maximum Capacity 700 lbs. per batten

Lighting System



House Board

The light booth is located in the back left of the auditorium.

Manufacturer: Electronic Theatre Controls, Inc. installation June 2013.

This board is an Eos Ti 3 w/10,000 control channels, 10,000 cues, and 1000 groups with touchscreen control and ETC universal fader wing 2x20.

Radio Focus Remote Unit (RFRU) located stage right.

DMX lighting control input stage right.

Dimmers

ETC sensor 2.4k dimmer per circuit.

Circuiting

House circuits are wired with 20 amp 2p&g Connectors.

Location	Available Circuits	Circuit Numbers
Front of House: First Cove	12 Circuits	193-204
Front of House: Second Cove (Note: 2nd cove is only used due to bad angles from 1 st cove)	20 Circuits	205-224
Front of House: House Right Loge	6 Circuits	257-262
Front of House: House Left Loge	6 Circuits	263-268
Stage: 1 st Electric	48 Circuits	1-48
Stage: 2 nd Electric	20 Circuits	97-116
Stage: 3 rd Electric	20 Circuits	117-136
Stage: 4 th Electric	20 Circuits	137-156
Stage: 5 th electric	16 Circuits	157-172
Side Slots: Stage Left	8 Circuits	270-277
Side Slots: Stage Right	8 Circuits	278-285
Catwalk: Stage Right	2—6 Circuit Drop Boxes; 1—4 Circuit Box	225-230; 231-236; 237-240
Catwalk: Stage Left	2—6 Circuit Drop Boxes; 1—4 Circuit Box	241-244; 245-250; 251-256
Floor Pockets: Upstage Stage Left-Right	36 Circuits Total (9 boxes across upstage wall)	49-80
Floor Pockets: Stage Left	8 Circuits	81-84; 89-92
Floor Pockets: Stage Right	8 Circuits	85-88; 93-96
House Lights	25 Circuits	289-313
Orchestra Shell	15 Circuits Total in Shell Ceiling; 8 Circuits Total Front of House	314-329; 330-337

Company Switch

The company switch is located stage right, up one level. 25 foot run to stage right wing.

2—400 amp legs, 3 phase, 5 wire, 120/208v a.c., (800 amp service). CAM LOK connection.

Cold water or chassis ground.

Lighting Equipment

Lights & Intelligent Attachments	
S4 19 Degree	45
S4 26 Degree	50
S4 36 Degree	50
S4 50 Degree	10
S4 70 Degree	5
S4 90 Degree	5
S4 Pars	100
Color Force 72 LED Cyc Lights	8
Martin Mac 101	16
Martin Mac 700	8
Martin Mac Aura	12
S4 WRD 36 Degree	12
Desire D60 LED	6
Desire D40 LED	3
LUSTR Series 3	8
Altman Spectra CYC 100 (RGBW)	6
Altman Spectra CYC 100 (RGBA)	3
Pipes, Bases, Arms, & Hardware	
50lb Boom Bases	8
20' Boom Pipes	6
12' Boom Pipes	8
1" Pipe Sidearms	40
12' Vertical Extension Tubes	10
18" Vertical Extension Tubes	5
Floor Plates	35
Cable Troughs	25
Light Ladders	2
Scenery Bumpers	6
Cables, Connectors, & Circuit Boxes	
Multiplex 2fers	20
Molded Stage Pin 2fers	36
Molded Stage Pin 3fers	12
Female Edison to male stage pin adaptors	10
Male Edison to female stage pin adaptors	10
50' Stage Pin	20
25' Stage Pin	20
20' Stage Pin	20
15' Stage Pin	20
10' Stage Pin	50
5' Stage Pin	50
30' Socaplex cable	2
Male socaplex breakouts	2
Female socaplex breakouts	2
Socaplex boxes	4
Spotlights & Lamps	
Spot #1- Lycian 1275 Superstar (1057hrs 7/18/22)	?
Spot #2- Lycian 1275 Superstar (916hrs 7/18/22)	?

Sound System

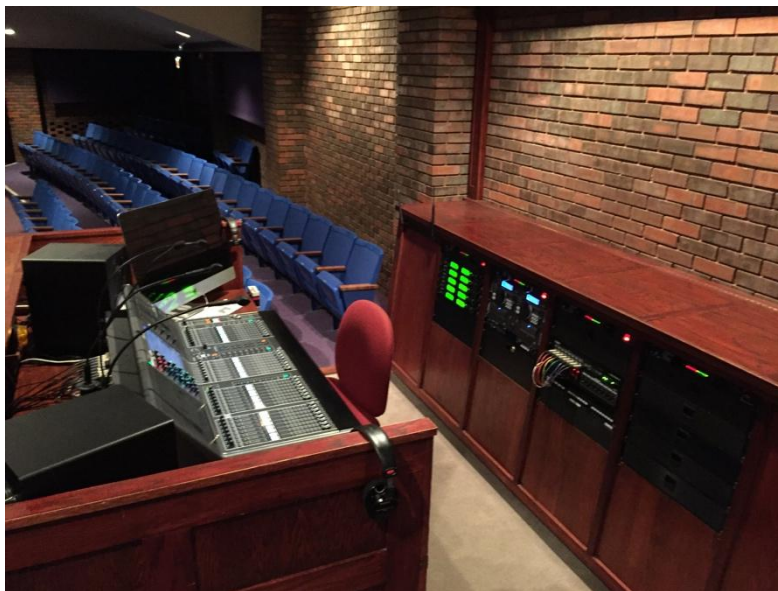

Main Speakers

Center Cluster:

- 2—EAW MQ1364e
- 2—EAW MQ1366e
- 2—EAW MQTD415

Stereo Left & Right:

- 2—EAW KF 695e
- 2—EAW KF 695z
- 2—Sub Meyer 650 R2

House Mixer

The mix position is an “open air” console at the back of the house.

Yamaha CL5 Digital Board:

- 72 Mono Channels + 8 Stereo Channels, 24 Mix Busses and 8 Matrix Buses
- Custom Fader Banks
- Editable Channel Names and Colors
- 48v Phantom power available to all channels
- Premium Rack
- Effect Rack
- Graphic EQ Rack
- 2 Track USB recording or playback
- Dugan Automatic Gain Control up to 16 Mic inputs
- 300 scenes
- 4 band parametric equalization and 2 dynamic processors on every input channel
- 16 DCA groups and 8 mute groups
- 16 User Define Keys and 4 User Define Knobs
- Dante Network to Rio 3216-D and Rio 1608-D

System Computing:

- 1—Apple iMac 27” with Retina 5K Display 3.5 Quad-core Intel Core 16GB 1600MHZ DDR3 SDRAM
- 2—Apple iPad AIR 2
 - 1—Apple AirPort Time Capsule

Playback & Recording Equipment

Equipment:

- 1—Tascam CD-X1700 Dual CD Player
- 1—Tascam SS-CDR1 CD Recorder

Monitor Systems

On Stage Monitor System:

- 10—EAW SM 200 a 2-way switchable (passive/bi-amped) full range system
- 4—DBX 166XL Compressor/Limiter for the Crown Macro-tech 1202 amplifier
- 4—Crown Macro-tech 1202 amplifier for the SM 200
- 1—Hotspot monitor

In Ear Monitor System:

- 2—Shure PSM 1000 P10T G10
- 4—Shure PSM 1000 P10R G10

The monitor rack is connected stage left.

The program monitor system can take signal from overhead microphones.

Paging System

Paging into three zones can be performed from Stage Right or Stage Left. These zones are the Greenroom, the Dressing Rooms, and three front-of-house booths. The volume controls are defeated during paging to assure an intelligible page. A page may be made from the recording booth or box office to the Greenroom, Dressing Rooms, front-of-house booths, or Lobby. However, the volume controls can be defeated to those designated areas.

Wireless System

Kirkland Fine Arts Center uses their own wireless communication system throughout events. It is the client's responsibility to get approval from the Kirkland Fine Arts Center Technical Director if the client would like to use their wireless system during an event. Clients also need to check with the Production Manager to find out if the client's wireless system is compatible with Kirkland Fine Arts Center's system.

Sound Circuiting

8 Omni inputs and 8 Omni outputs at the rear of the sound board.

1 Rio 1608-D stage box located at the FOH mix position, 1 Rio 3216-D located Backstage Stage Left, 1 Rio 1608-D mobile rack with 100ft Ethernet/power cable.

Microphones

Brand	Microphone Type	Notes	Quantity
AKG	414	Large Condenser	4
AKG	430	Small Condenser	4
AKG	451	Small Condenser	5
AKG	C418	Drum Mics	4
AKG	D112	Bass Drum Mic	1
AKG	1000	Large Condenser	5
BB	Bachaus Berry	Piano Pickup	2
Countryman	DI Box	Type 85	5
Crown	CM31	Choral Hanging Mic	6
Crown	PCC 160	Boundary Floor Mic	5
Crown	PZM 3GPM*	Boundary Mic	2
Crown	PZM 6LPG*	Boundary Mic	1
Crown	PZM 30 RB	Boundary Mic	2
Crown	PX18	Phantom Power Supply	1
Helpinstill	Piano Mic	Piano Pickup	2
I-FACE		XLR to RCA	2
Sennheiser	421	Large Condenser	2
Shure	Beta 57	Dynamic	1
Shure	SM57	Dynamic	10
Shure	Beta 58	Dynamic	10
Shure	SM58	Dynamic	10
Shure	Super 55	Dynamic	2
Shure	SM87	Dynamic	2
Shure	Mx418 SE/C	Cardioid Condenser Lectern Mic	2
Shure	UR4D-G1	UHF-R Wireless Receivers @ FOH Rack	12
Shure	UR1-G1	UHF-R Wireless Body Pack Transmitter	12
Shure	UR2-G1	UHF-R Wireless Handheld Mic SM BETA 58	12
Shure	VP88	Stereo Microphone	2
Countryman	E-6 Lavaliers—Nude	Omnidirectional Earset Mic	10

** Requires Crown PX18*

Sound Accessories

Microphone Stands and Clips:

- 20—Microphone Stands w/Circular Bases
- 20—36" Microphone Boom Arms
- 4—Tall Tripod Microphone Stands with Boom Arms
- 4—Short Tripod Microphone Stands with Boom Arms
- 8—Desktop Short Microphone Stand
- 8—Short Weighted Microphone Stand with Boom Arms

Cables:

- 50—XLR 25'
- 25—XLR 50'
- 10—Speakon 5'
- 10—Speakon 25'
- 10—Speakon 50'
- 5—Speakon 75'
- 5—Speakon 100'
- 5—Speakon Adapters
- 3—100' 8 Channel XLR Snake
- 1—50' 8 Channel XLR Snake
- A good supply of cable extensions and adapters is also available

Theatre Communications

A Clear-Com single channel system is wired to all technical areas of the theatre.

Clear-Coms:

- 3—Clear Com FreeSpeak II 1.9 GHz 2 channel
- 1— HME Pro 850 2 channel Base station
- 4— HME Pro 850 2 channel Wireless Transmitter Packs
- 18 (Missing 4)-Clear Com Packs
- 1—Clear Com Portable Speaker Box (at Light Board)
- 19 (Missing 9)-Single Muff Headsets
- 10-XLR Cable (yellow, for Clear Com use only)

Supplemental P.A.

Placement of house mix desk is in the “open air” booth at the back of the orchestra seating (200’ snake run from backstage).

Local fire codes prohibit placement of equipment in the aisles. Microphone snakes must be run up the center of the seating and secured.

Upon *prior* approval by the Kirkland Fine Arts Center Production Manager, seats may be reserved for the placement of any additional sound equipment used for touring shows. **Reserved seats CANNOT be removed!**

The seats that may be reserved are:

Row 27—Seats L12-L24

Row 28—Seats L12-L24

Row 29—Seats L12-L24

Wenger 4’ x 8’ Versalite risers with telescoping legs will be set-up as a table upon request.

Company Switch

Company Switch is located in the Stage Left wing.

- 1—200 AMP 3 Phase 5 Wire, 120/208v a.c. CAM LOK Connection w/ Isolation Ground Transformer
- 1—100 AMP 3 Phase 5 Wire, 120/208v a.c. CAM LOK Connection w/ Isolation Ground Transformer

Millikin University - Kirkland Fine Arts Center

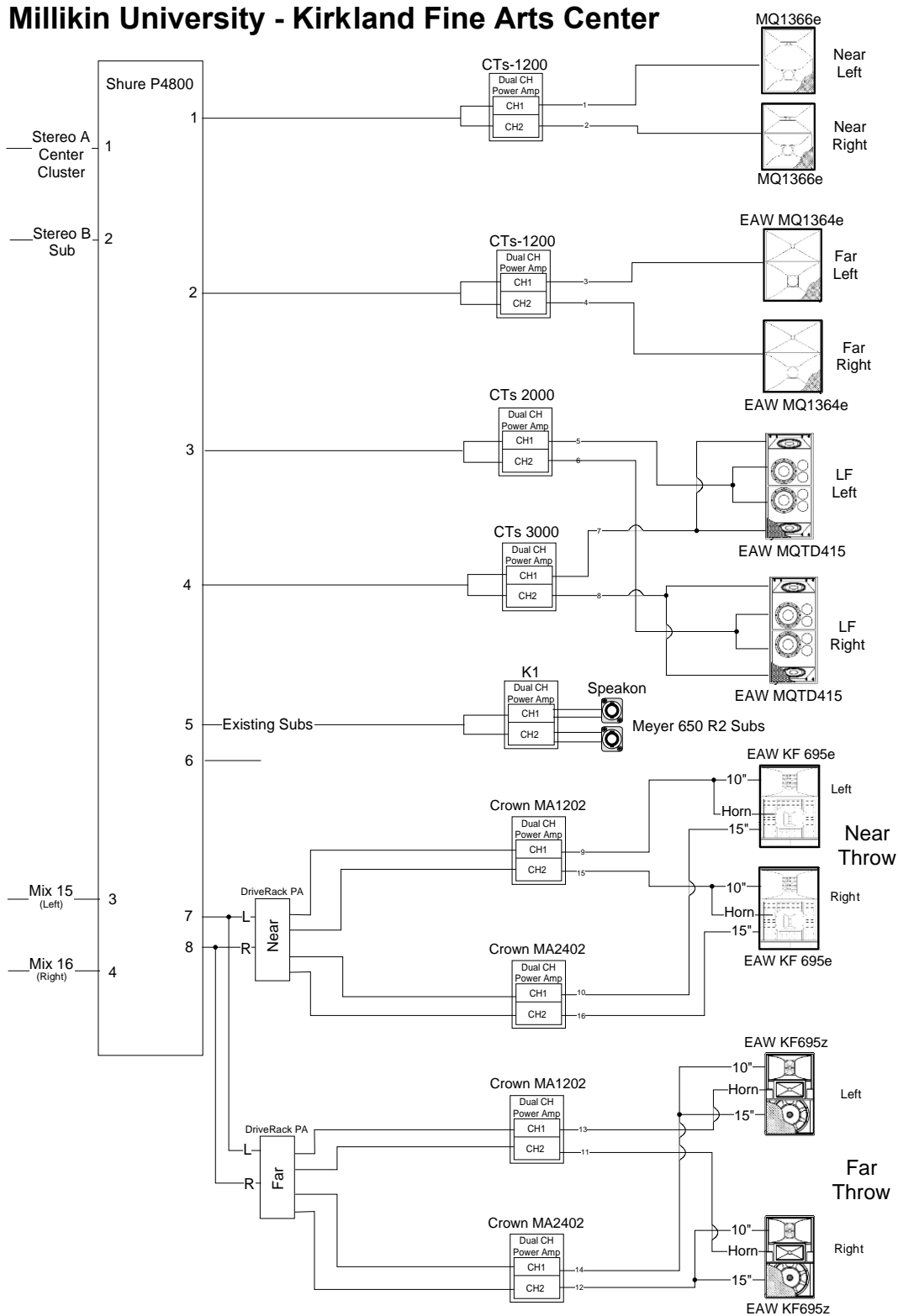



Integrated Audio Systems, Inc.
 7708 N. Crestline Dr. • Peoria, Illinois 61615-1907
 Phone: 309-693-1916 Fax: 309-693-2507

Job Name: Millikin University - Kirkland Fine Arts Center			Date: 01/31/06
SM: KJ	PM:	DM: RB	REV As Built 04/21/06 05/15/06

General Auditorium Information

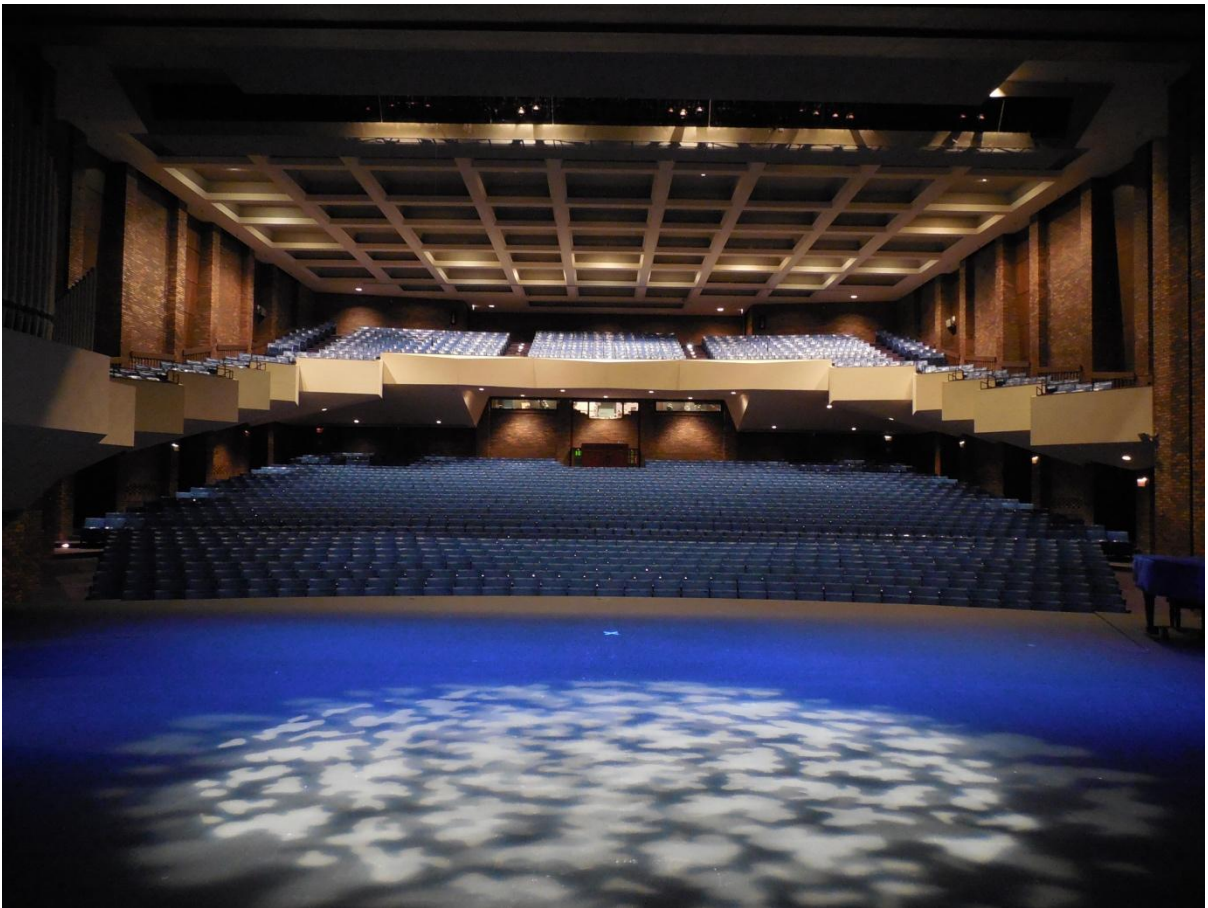

Auditorium Seating Plan

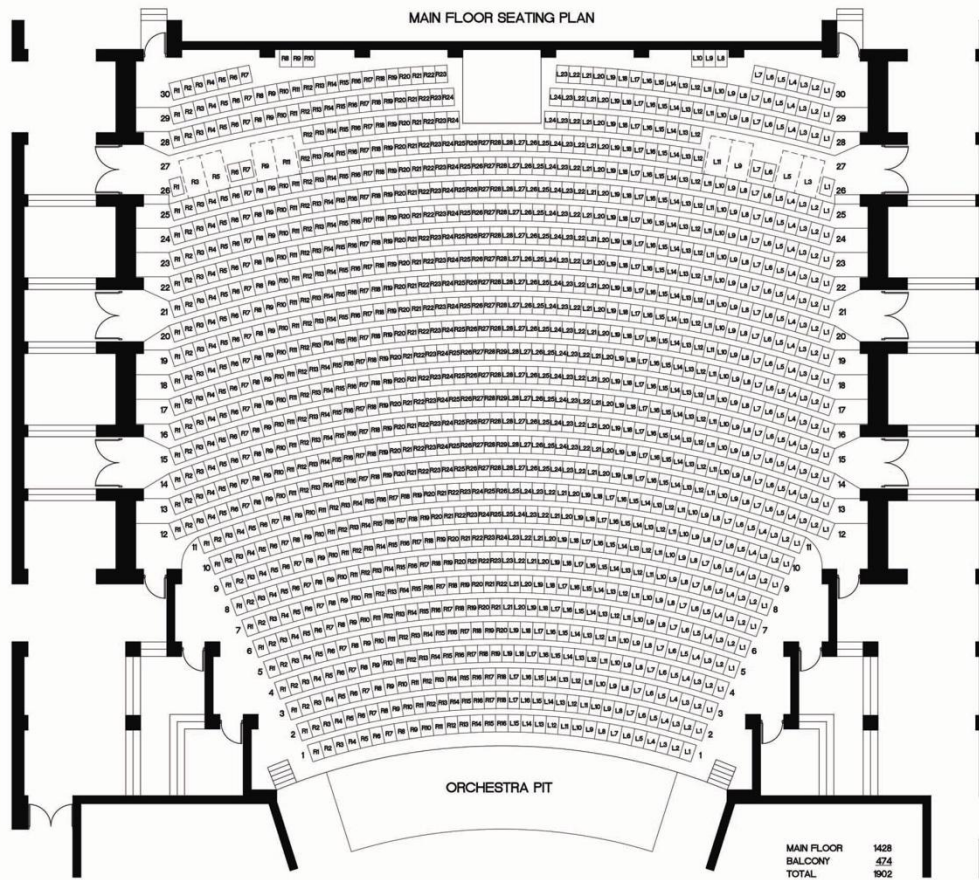
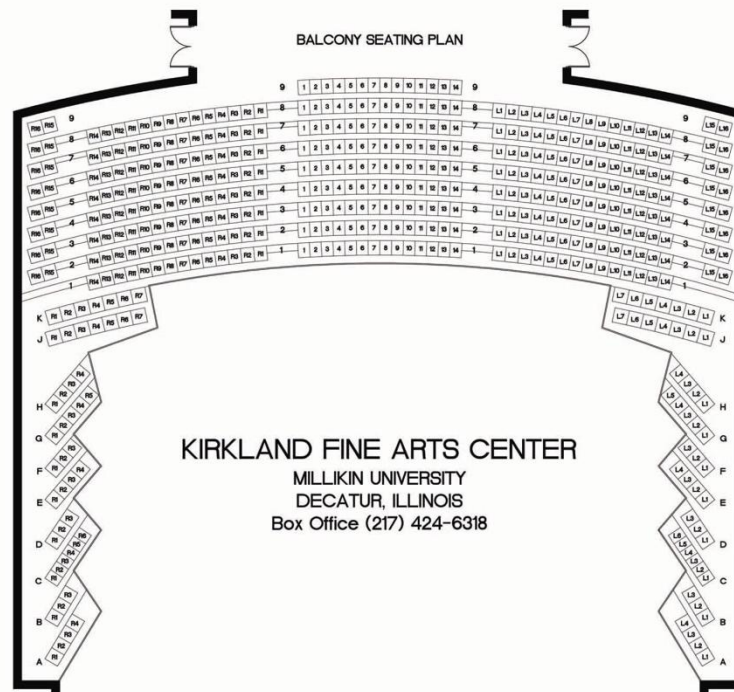

Kirkland Main Level Ground Plan

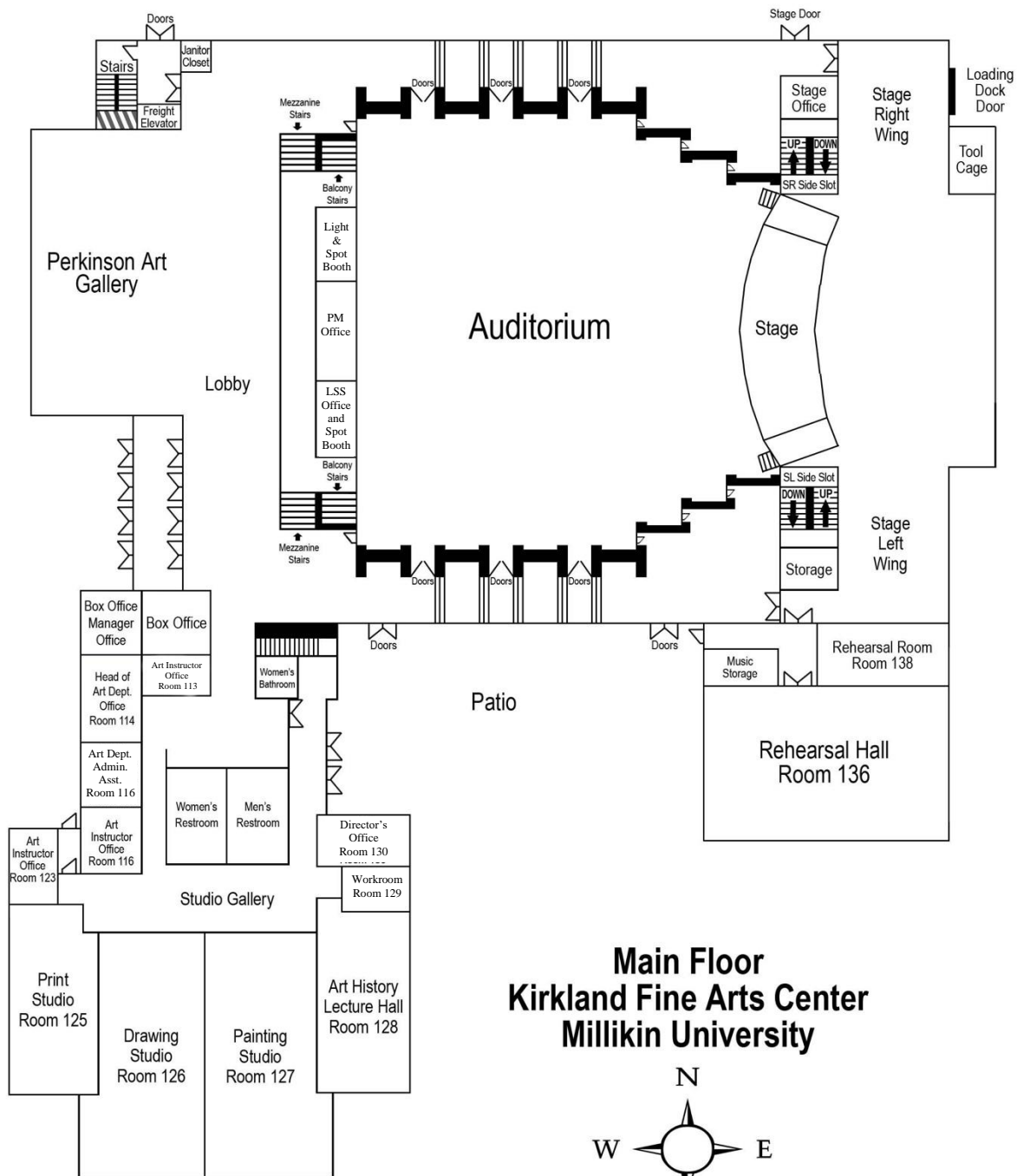

Kirkland Lower Level Ground Plan

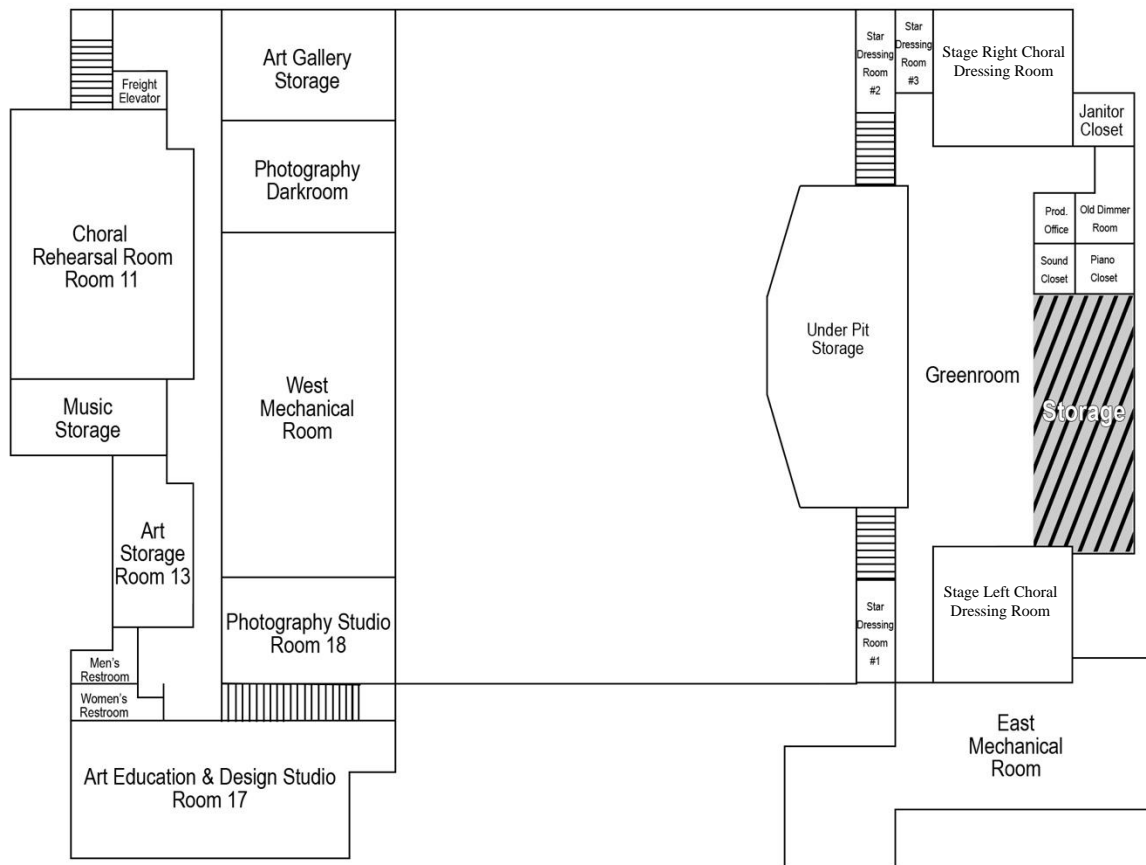

Lower Level Kirkland Fine Arts Center Millikin University

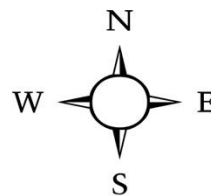

Dressing Rooms, Green Room, and Backstage Visitor's Information

Use of Spaces:

All Dressing Rooms and the Green Room are located one level below the stage with accessibility via stairwells on stage right and stage left. Wardrobe can be taken to the dressing rooms on the hydraulic pit lift. There are no stage-level facilities available.

Rooms Available:

- 2—Large Choral dressing rooms (1—SR, 1—SL). Approximately 27' x 24' each
- 3—Private dressing rooms (2 people each). Two are located across from the SR choral dressing room and one across from the SL choral dressing room.
- 1—Large Green Room separating the two choral dressing rooms
- 1—Production Office. Approximately 6'x16' with 3 chairs

Dressing Rooms:

SR choral dressing room has 10 mirrors plus 1 full-length mirror

SL choral dressing room has 9 mirrors plus 1 full-length mirror

Private dressing rooms have 2 mirrors plus 1 full-length each

Green Room:

Several sofas and armchairs are located in the Green Room area along with dining tables and chairs.

A drinking fountain is also located in the Green Room area.

The janitor's sink, located just off of the Green Room, is available for use *upon request*.

A washer and dryer are located just off of the Green Room area and may be used *upon request*.

Millikin University campus policy prohibits smoking, drinking, and eating in the building. With prior approval, the Green Room may be used for hospitality items only.

Internet Access:

Wireless Internet is available in all dressing rooms and green room log in information will be posted for events held in Kirkland.

Campus Security:

Kirkland Fine Arts Center needs **4 weeks** notice prior to an event if any special security is needed at the doors or dressing rooms.

Campus Security emergency phone number is (217) 464-8888 or *6388

Special Effects:

Kirkland Fine Arts Center needs **4 weeks** advance notification for approval of these special effects: haze, fire, guns, special rigging and strobe. Proof of certification is required, in advance, per special field. An announcement will be made prior to the performance to alert the audience of special effects used, i.e. strobe, guns.

Campus Security will contact the Decatur Fire Marshall and make arrangements to observe the effects during load-in.

The use of pyrotechnic devices and/or open flame sources is forbidden without prior consent from Kirkland Fine Arts Center.

Theatrical Suppliers

Brent Theatrical Lighting

2905 Eagle Ridge Court
Springfield, IL 62711
Tel (217) 546-9608
Fax (217) 546-4363
www.brenttheatricallighting.com

Prosource

608 Kerr Avenue #21
Urbana, IL 61802
Tel (855) 865-8835
www.prosourcehub.com

Knox-Array Event Production

1305 North McKinley Avenue
Champaign, IL 61821
Tel (217) 355-3700
www.knoxarray.com

Medical Emergency Contact Information

Dial 911

Millikin University Campus Security: (217) 464-8888

Hospitals:

Decatur Memorial Hospital

Emergency Care Center
2300 N. Edward Street
Decatur, IL 62526
www.dmhcares.com
(217) 876-8121

St. Mary's Hospital

Emergency Department
1800 E. Lake Shore Drive
Decatur, IL 62521
www.stmarys-hospital.com
(217) 464-2966

Clinics:

Community Health Improvement Center

2905 N. Main Street
Decatur, IL 62521
(217) 877-9117

Family Medical Care of Decatur

1770 E. Lake Shore Drive
Decatur, IL 62521
(217) 428-3424

SIU Family Physicians

250 W. Kenwood Avenue
Decatur, IL 62526
(217) 872-3800

Traveling Information



Map—Illinois Reference

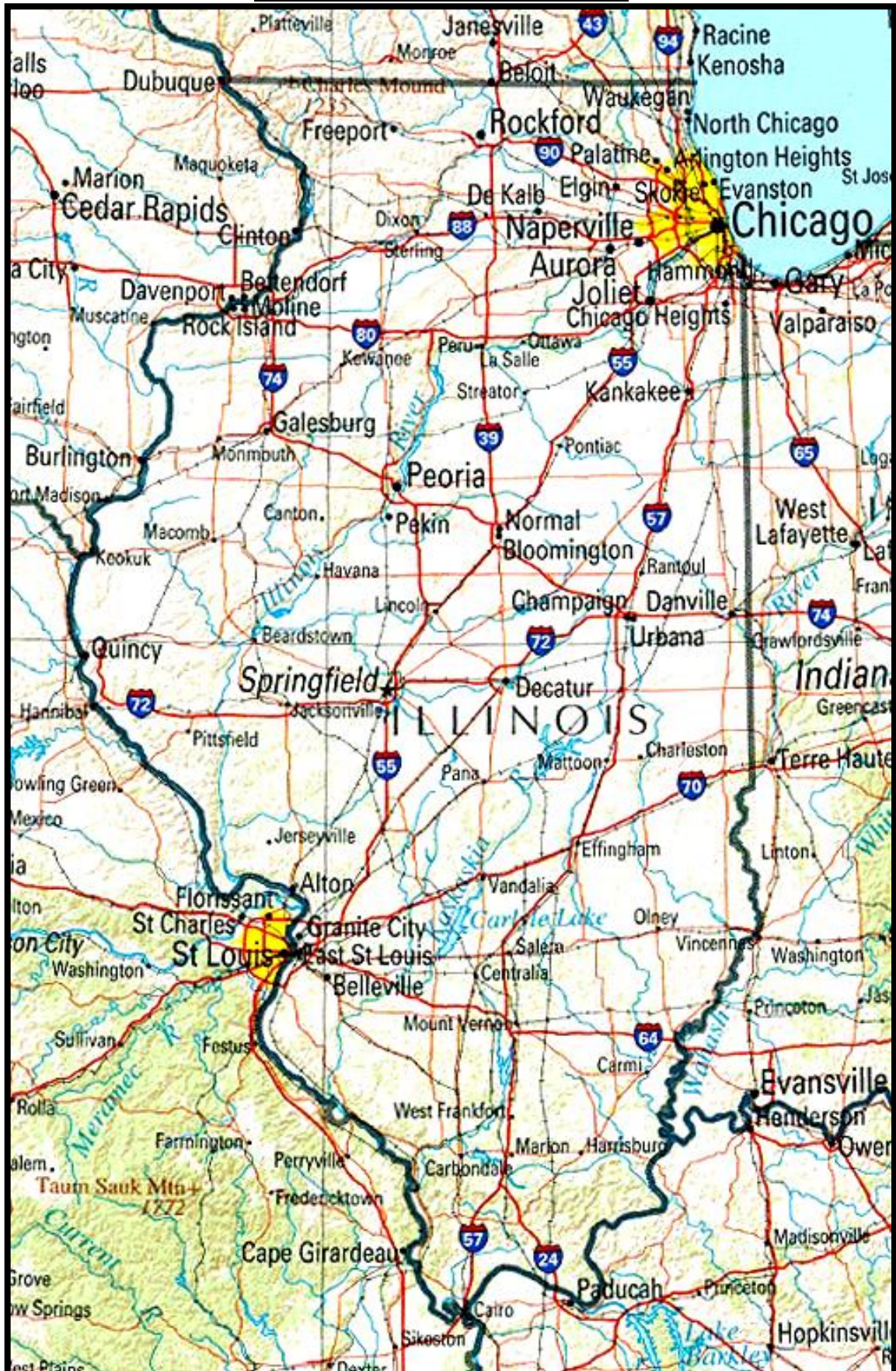

Map—Champaign/Urbana to Decatur



Map—Springfield to Decatur



Map—Bloomington to Decatur



Transportation

Airports:

- Decatur Airport (217) 428-2423
- Chicago O'Hare Airport
- Chicago Midway Airport
- St. Louis Lambert Airport (314) 426-8000
- U of I Willard Airport (217) 244-8618

Ground Transportation:

- Avis Rent-A-Car (217) 422-4337
- Baldwin Shuttle Service (217) 422-5906
- Enterprise Rent-A-Car (217) 875-4900
- Greyhound Bus Lines (217) 877-6262

Map—Decatur Area

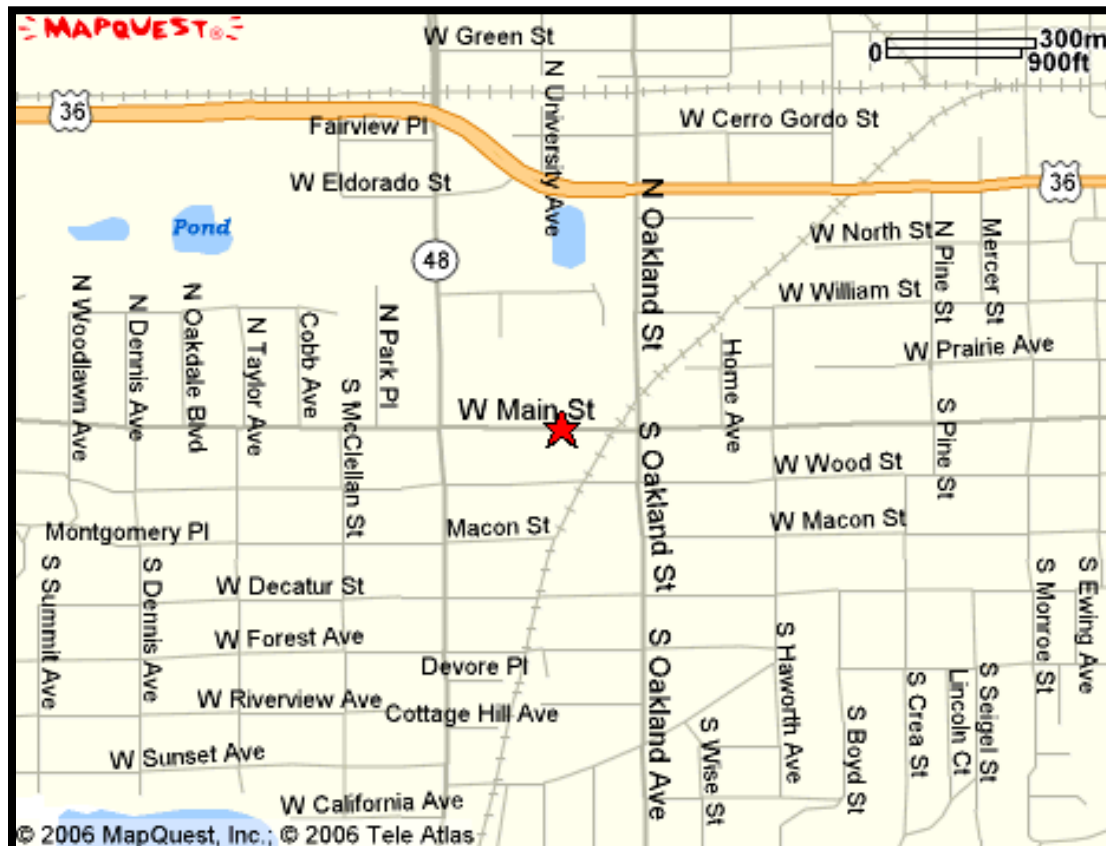

Map—Millikin University



DECATUR, ILLINOIS

Centrally located in the heart of the Midwest, Millikin is just three hours from Chicago, St. Louis, and Indianapolis.

MILLIKIN UNIVERSITY CAMPUS MAP

millikin.edu/tour

Academic / Administration

- 1 ADM-Scovill Hall
Taylor School of Business, Center for Entrepreneurship, SCORE
- 2 Alumni/Development Center
- 6 Dolson Hall Office of Residence Life
- 24 Exercise Science & Sport Pavilion
- 3 Gorin Hall Admission Office, Registrar, Marketing
- 4 Griswold Physical Education Center
- 10 Hub Business Incubator
- 5 Leighty-Tabor Science Center
- 13 Millikin/DMH Health Clinic
- 8 Parkinson Music Center
- 7 Pilling Chapel
- 11 Future Center for Theatre & Dance
- 9 Shilling Hall
- 12 University Commons

Athletics

- 16 Bartlett Tennis Courts
- 17 Decatur Indoor Sports Center (DISC)
- 14 Department of Athletics
- 18 Frank M. Lindsay Track & Field
- 4 Griswold Physical Education Center
- 19 Workman Family Softball Field
- 20 Future Workman Family Baseball Field

Dining

- 11 Big Blue Bistro - RTUC (Lower Level)
- 1 Café ala Carte - ADM-Scovill Hall
- 9 Domino's, Subway, University Dogs
- 9 Einstein Bros Bagels - Shilling Hall (North Entrance)
- 28 Jimmy John's
- 11 Wornick Dining Room - RTUC (Upper Level)

Housing

- 29 Alpha Chi Omega
- 31 Aston Hall
- 32 Blackburn Hall
- 33 Delta Delta Delta
- 6 Dolson Hall
- 36 Huss House
- 37 Millikin East & West Apts.
- 41 New Hall 4
- 42 Pi Beta Phi
- 43 Sigma Alpha Epsilon
- 12 Staley Library
- 44 Tau Kappa Epsilon
- 45 Walker Hall
- 46 Weck Hall
- 47 The Woods at Millikin Apartments

Fine & Performing Arts

- 9 Albert Taylor Theatre
- 22 3D Arts & Theatre Center
- 3 Birks Museum
- 23 Kirkland Fine Arts Center
- 25 Old Gym
- 48 Percussion House
- 8 Parkinson Music Center
- 7 Pilling Chapel
- 24 Pipe Dreams Studio Theatre
- 24 SPFC

Public Safety

- S Public Safety
- + Emergency
- X Dining

♿ Handicapped parking available in all lots.



MILLIKIN
UNIVERSITY®

1184 W. Main St. Decatur, IL 62522

Decatur Area Lodging Information

North Decatur/Forsyth:

Baymont Inn

5100 Hickory Point Frontage Road
Decatur, IL 62526
(217) 615-3780

Country Inns & Suites

5150 Hickory Point Frontage Road
Decatur, IL 62526
(217) 872-2402
Forsyth, IL 62535

Fairfield Inn

1417 Hickory Point Drive
Forsyth, IL 62535
(217) 875-3337

Hampton Inn

1429 Hickory Point Drive
Forsyth, IL 62535
(217) 877-5577

Quality Inn

134 Barnett Avenue
Forsyth, IL 62535
(217) 875-1166

Ramada Limited

355 E. Hickory Point Road
Decatur, IL 62526
(217) 615-4768

Northeast Decatur:

Sleep Inn

3920 E. Hospitality Lane
Decatur, IL 62521
(217) 872-7700

Southeast Decatur:

Hawthorn Suites

2370 South Mt. Zion Rd.
Decatur, IL 62521
(217) 864-9311

West Decatur:

Decatur Conference Center & Hotel

4191 U.S. Rt. 36 West & North Wyckles Rd.
Decatur, IL 62522
(217) 422-8800

Decatur Area Dining Information

Near Millikin University:

Domino's 1135 West Wood Street (217) 422-2244	\$	Sun-Thurs 10:30am-12:00am Fri-Sat 10:30am-1am
Donnie's Homespun 190 N Merchant Street (217) 424-4344	\$\$	Fri-Sat 11:00am-8:00pm Sun Closed
Door Four Brewing 1214 W Cerro Gordo St. 217-330-2008	\$\$	Mon-Tues Closed Wed 11:00am-9:00pm Thurs-Sat 11:00am-10:00pm Sun 11:00am-4:00pm
First Wok 1683 West King St (217) 423-2900	\$\$	Mon Closed Tues-Thurs 11:00am-9:30pm Fri-Sat 11:00am – 10:00pm Sun 12:00pm-9:30pm
Garden Family Restaurant 696 E. Pershing Rd. (217) 872-7227	\$	Sun-Sat 6:00am-9:00pm
Hardee's 1080 West Eldorado Street (217) 428-6100	\$	Sun-Sat Open 24 Hours
McDonald's 962 West Eldorado Street (217) 422-8149	\$	Sun-Sat Open 24 Hours
Pizza Hut 1671 West King Street (217) 422-2600	\$\$	Sun-Thurs 10:00am-12:00am midnight Fri-Sat 10:00am-1:00am
Sloan's Calzones 129 South Oakland St. (217) 429-7411	\$\$	Mon-Wed 11:00am-8:00pm Fri-Sat 11:00am-9:00pm Sun closed
Subway 975 W Eldorado St (217) 429-0496	\$	Mon-Fri 7:00am-9:00pm Sat-Sun 9:00am-8:00pm
University Dogs 1105 West Wood Street (217) 422-2288	\$	Mon-Sat 11:00am-8:00 pm Sun closed
Wing Stop 1491 West King Street (217) 424-9464	\$	Sun-Sat 11:00am-12:00am midnight

Downtown Decatur:

The Beach House 2301 East Lakeshore Drive (217) 422-7202	\$\$	Sun-Mon Closed Tues-Fri 11:00am-1:00pm/5:00pm-8:00pm Sat 5:00pm-8:00pm
Decatur Brew Works 102 E William Street 217-330-8683	\$	Sun-Mon Closed Tues-Thurs 3:00pm-9:00pm Fri 3:00pm-10:00pm Sat 2:00pm-10:00pm
Downtown Café 217 North Main Street (217) 428-1120	\$	Mon-Sat 6:30am-2:00pm Sun 8:00am-2:00pm
Robbie's Grill 122 N. Merchant Street (217) 423-0448	\$\$	Tues-Fri 11:00am-2:00pm/5:00pm-8:00pm Sat-Mon closed
Taproot 170 N Merchant St (217) 330-6365	\$\$	Wed-Sat 4:00pm-8:00pm Sun-Tues Closed

West Decatur:

Pop's Place 4335 W Main St. (217)330-6546	\$	Mon-Thurs 10:00am-12:00am Fri-Sat 10:00am-1:00am Sun 10:00am-10:00pm
--	----	--

North Decatur

Aloha 3025 North Kandy Lane (217) 875-5540	\$\$	Tues-Sun 3:00pm-7:30pm Mon closed
Asia House 3074 North Water Street (217) 875-7900	\$\$	Mon, Wed-Thurs. 11:00am-9:30pm Tues Closed Fri-Sat 11:00am-10:00pm Sun 12:00pm-9:00pm
Bob Evans Restaurant 3020 North Water Street (217) 875-4577	\$	Mon-Sun 7:00am-9:00pm
Culver's 2994 North Water Street (217) 875-2900	\$	Sun-Sat 10:30am-10:00pm
Dairy Queen 610 Snyder Street (217) 877-4131	\$	Mon-Sun 5:30am-10:00pm
KFC 1310 East Pershing Road (217) 872-1725	\$	Sun- Sat 10:30am-11:00pm
La Gondola 2034 South Mt. Zion Road (217) 864-4333	\$	Tues-Thurs 11:00am-7:00pm Fri-Sat 11:00am-9:00pm Sun-Mon Closed

McDonald's 3005 North Water Street (217) 877-9259	\$	Sun-Sat Open 24 Hours
Olive Garden 3795 N Water Street (217) 877-7470	\$\$	Sun-Sat 11:00am-10:00pm
Panera Bread 255 East Ash Avenue (217) 872-6435	\$	Sun-Sat 7:00am-9:00pm
Perkins Restaurant 2999 North Monroe Street (217) 619-8360	\$\$	Sun-Sat 6:00am-8:00pm
Steak-n-Shake 1330 East Pershing Road (217) 877-3231	\$	Sun-Sat 10:00am-12:00 midnight
Taco Bell 753 East Pershing Road (217) 876-1310	\$	Sun-Sat 7:00am-2:00am
Wendy's 102 West Pershing Road (217) 872-6442	\$	Sun-Sat 6:30am-1:00am
<u>Forsyth</u>		
Applebee's Grill & Bar 1275 South Route 51 (217) 875-0281	\$\$	Sun-Thurs 11:00am-11:00pm Fri-Sat 11:00am-12:00 midnight
Buffalo Wild Wings 851 South US Rt 51 (217) 877-8370	\$	Sun-Thurs 11:00am-11:00pm Fri-Sat 11:00am-12:00 midnight
Panda Express Hickory Point Mall (217) 875-5912	\$	Mon-Sat 11:00am-8:00pm Sun 12:00 noon-5:00pm
Red Lobster 997 South Route 51 (217) 875-3196	\$\$	Sun-Thurs 11:00am-9:00pm Fri-Sat 11:00am-9:00pm
Steak 'n Shake 920 South Main, Rt 51 (217) 876-0107	\$	Mon-Sun 10:00am-12:00 midnight
Texas Roadhouse 1155 North Route 51 (217) 876-7380	\$\$	Mon-Thurs. 3:00pm-10:00pm Fri 3:00pm-11:00pm Sat. 11:00am-11:00pm Sun. 11:00am-9:00pm
\$ ----\$5.00-\$10.00	\$\$----\$10.00-\$20.00	\$\$\$----\$20.00-\$30.00