

*Kirkland* Fine Arts Center  
MILLIKIN UNIVERSITY



# Technical Information

Kirkland Fine Arts Center  
Millikin University  
1184 West Main Street  
Decatur, IL 62522-2084

# **Table of Contents**

## **Stage Information:**

5. Stage Floor Plan with Measurements
6. North Section View of Theatre
7. Loading and Stage Information
  - Loading
  - Stage
8. Orchestra Pit/Lift  
Orchestra Shell and Ceiling  
Musical Equipment
9. Risers  
Marley Dance Floor  
Ladders
10. Fly System  
Act Curtain  
Other House Soft Goods
11. Fly Line Sets

## **Lighting System:**

13. House Board  
Dimmers  
Circuiting  
Company Switch
14. Lighting Equipment  
Other Lighting Equipment

## **Sound System:**

16. Main Speakers  
House Mixer  
Playback & Recording Equipment  
Monitor Systems
17. Paging System  
Wireless System  
Sound Circuiting
18. Microphones  
Sound Accessories
19. Theatre Communications  
Supplemental P.A.  
Company Switch
20. Speaker System Diagram

## **General Auditorium Information:**

22. Auditorium Seating Plan (Main Floor and Balcony)
23. Kirkland Main Level Ground Plan
24. Kirkland Lower Level Ground Plan
25. Dressing Rooms, Green Room, and Backstage
  - Use of Spaces
  - Campus Security
  - Special Effects
26. Theatrical Suppliers
27. Medical Emergency Contact Information

## **Traveling Information:**

29. Map—Illinois Reference with Major Highways
30. Map—Champaign/Urbana to Decatur  
Springfield to Decatur
31. Map—Bloomington/Normal to Decatur Transportation
32. Map—Decatur Area
33. Map—Millikin University Campus
34. Decatur Area Lodging Information
35. Decatur Area Dining Information

## **Kirkland Fine Arts Center**

Millikin University  
1184 West Main Street  
Decatur, IL 62522-2084

Tel (217) 424-6253

Fax (217) 362-6417

kfac@millikin.edu

### **Managing Director:**

Jan Traughber  
jtraughber@millikin.edu  
(217) 424-3925

### **Patron Relations Manager:**

J.R. Baird  
jrbaird@millikin.edu  
(217) 424-6318

### **Technical Director:**

Bryan Diver  
bdiver@millikin.edu  
(217) 424-6341

### **Assistant Technical Director:**

Jared Kullmann  
jkullmann@millikin.edu  
(217) 424-6224

### **Events Coordinator:**

Mary Lynn Arnold  
marnold@millikin.edu  
(217) 424-6227

### **House Capacity:**

Orchestra Level	1428
Balcony	475
<b>Total</b>	<b>1903</b>

### **Public Accommodations:**

Eight Wheelchair Accessible Spaces

Eight Assistive Listening Devices available from the Box Office

**Business Hours:** Monday-Friday 8:00am-5:00pm Central Standard Time

**Box Office Hours:** Monday- Friday 10:00am-5:00p.m. Central Standard Time



# Stage Information





# Stage Floor Plan with Measurements

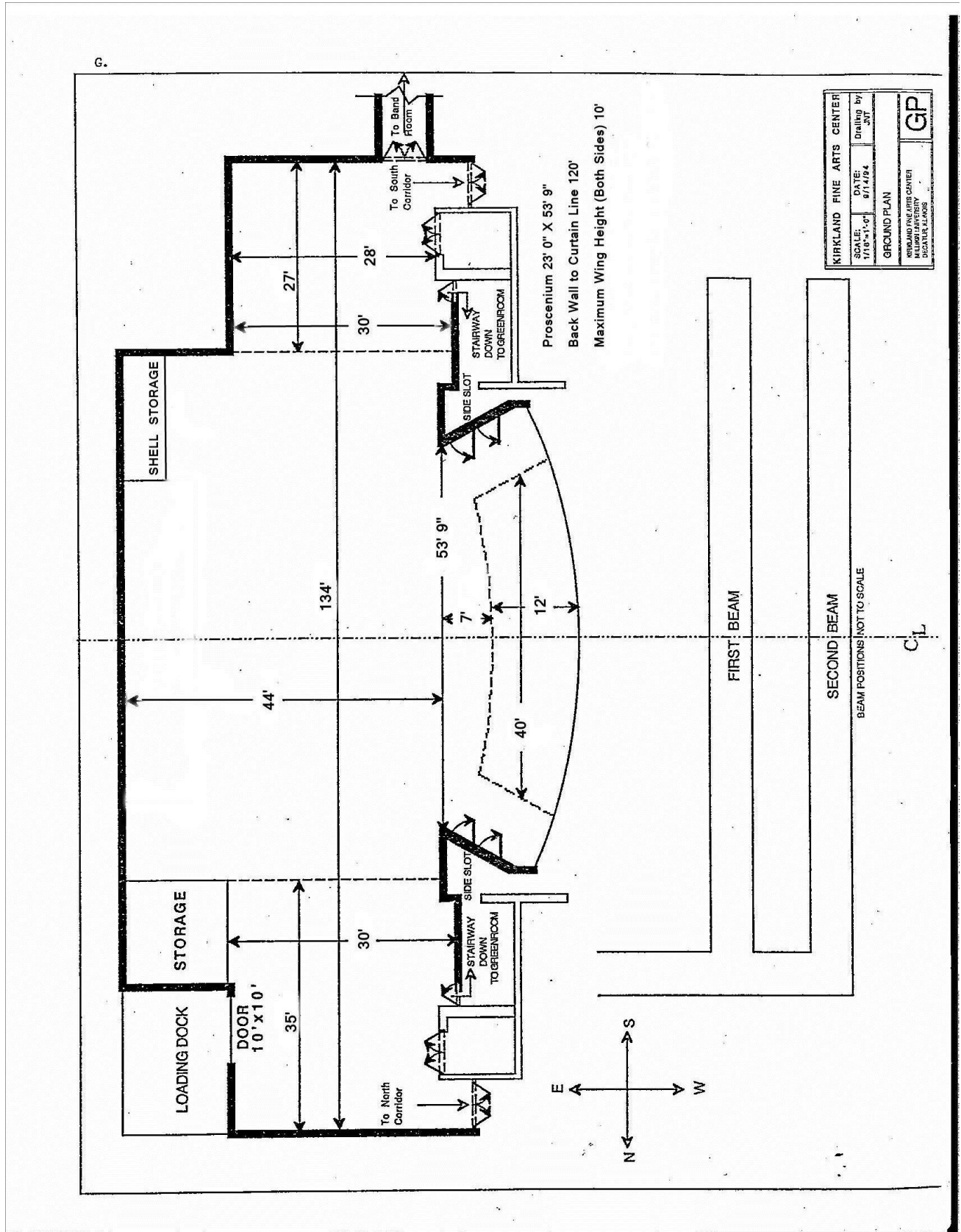

## North Section View of Theatre

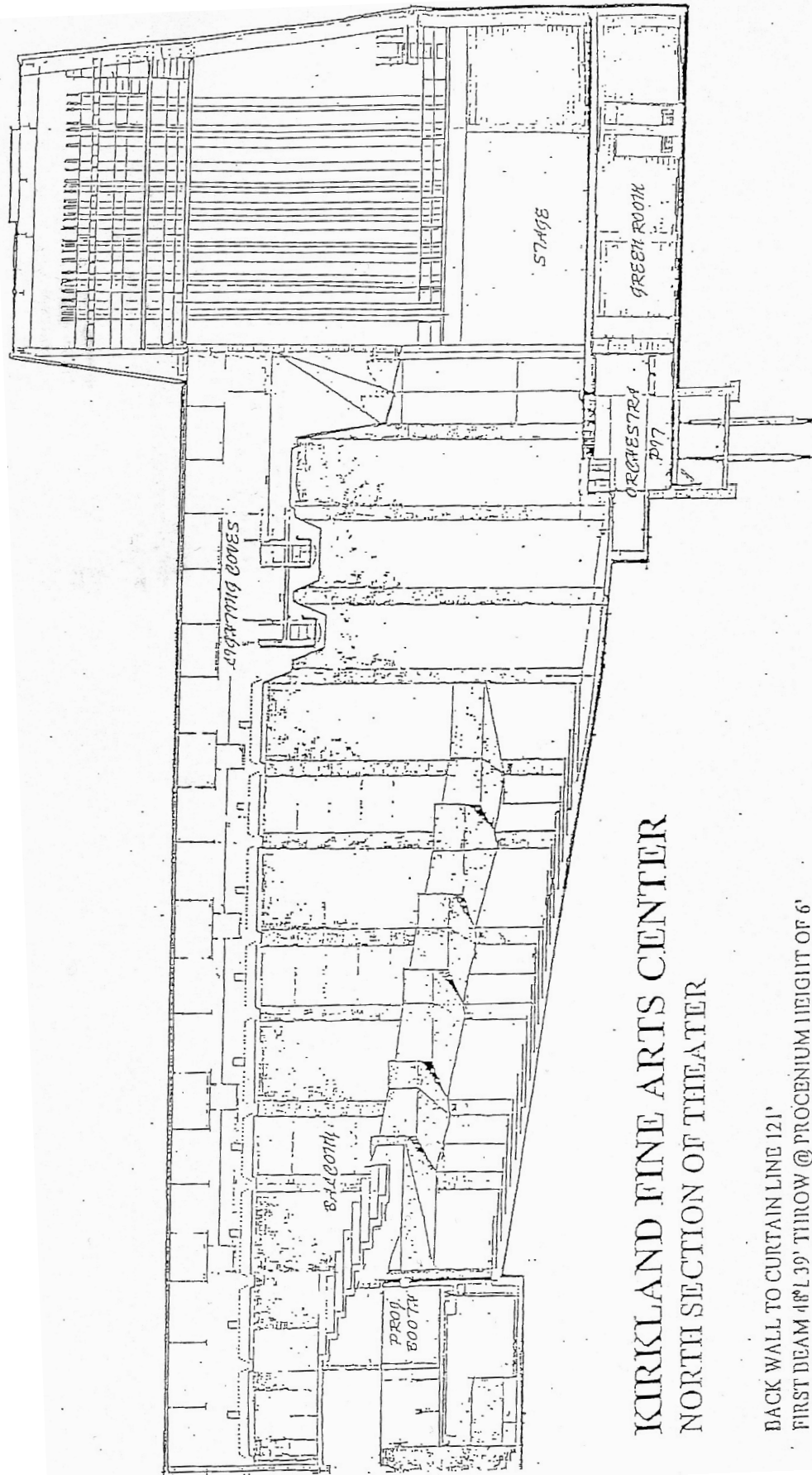

### KIRKLAND FINE ARTS CENTER NORTH SECTION OF THEATER

BACK WALL TO CURTAIN LINE 121'  
 FIRST BEAM 48' L 39' THROW @ PROSCENIUM HEIGHT OF 6'  
 SECOND BEAM 40' L 46' THROW @ PROSCENIUM HEIGHT OF 6'

## **Loading and Stage Information**

### **Loading:**

The loading dock door is located behind Kirkland Fine Arts Center. As you turn off Fairview Avenue, Kirkland Drive runs eastwardly between Leighty-Tabor Science Center and the Kirkland Parking lot. Follow Kirkland Drive between Kirkland and the adjacent cemetery. Truck must then back down a ramp leading to the loading dock entrance.

Two trucks may back down to the dock, which is an exposed concrete slab, 20' x 16', and raised 42" from the road level.

The dock door measures 10' x 10' and opens directly to the stage right wing. The maximum height of the stage right wing measures 10'.

### **One 5x5 dock plate is available for dock loading and unloading.**

Trucks may remain in the loading area from load-in through load-out if desired.

Bus parking is available in a driveway immediately behind Kirkland Fine Arts Center, or in the North Parking Lot of Millikin University's campus.

### **Stage:**

The stage door is located on the NORTH side of the building, near the dock door.

The stage floor is Masonite and soft fir, mounted on an air space (sprung floor).

NO nailing, screwing, or painting of the stage floor is allowed without the prior consent from the Technical Director.

No scene shop is available and tools are limited.

### **Measurements:**

*See page 2 for floor plan.*

Proscenium: Width—53'9" Height—23'

Proscenium to back wall: Depth—44'

Stage Apron: Depth—7' at center stage to the proscenium

Stage Wing Space: Stage Right—Depth 30' Width 35'  
Stage Left—Depth 30' Width 27'  
**Maximum Height (Both Sides) 10'**

Stage Width (wall-to-wall): 134'

Back of house from back wall to edge of pit: Length—100'

Back of house from back wall to curtain line: Length—120'

**NO items may be placed less than one foot downstage or upstage of flying goods. I.E. Act Curtains, Legs, Scrim, or Cyclorama.**

## Orchestra Pit/Lift

**Kirkland Fine Arts Center Technical Directors (TD), Assistant Technical Directors (ATD), Stage Managers (SM's), and Assistant Stage Managers (ASM's) are the only ones allowed to raise and lower the pit.**

No one is allowed to ride the pit other than the controller and any crewmember holding equipment. No performance can occur on a moving pit. Pit doors remain locked until the pit is locked down and declared safe by the above listed employees. No one is allowed to open doors to the pit to allow pit access to others.

Width—40'  
Depth—12'

Weight Capacity: 100-lbs/sq. foot (24 ton maximum)

Control is located on the stage right wall, or with removable remote control downstage center.

The pit is on a hydraulic lift with four preset levels. The pit can also be stopped at any position using the stop button.

Preset Levels:	4—Stage Level	0'0"
	3—House Level	3'6"
	2—Pit Level	8'0"
	1—Green Room	11'0"

Single access doors are located on Preset Level 2 (Pit Level) on stage right and stage left.

Double access doors are located on Preset Level 1 (Green Room) center stage.

## Orchestra Shell and Choral Shell

The “Diva” orchestra shell has four different arrangements combining ten walls and four 8” ceiling panels permanently hung over the stage. 26 Source Four par lighting instruments are mounted into the ceiling.

Dimensions:      Depth—34'10"  
                         Width—53'9"  
                         Height—23'

## Musical Equipment

**Pianos:** 2—Steinway 9' Grand Pianos. Excellent condition. Located on stage.  
1—Baldwin 9' Grand Piano. Good condition. Located in the lobby.  
1—Austin Pipe Organ (Opus #2519). Good condition. Located at pit level. Pipes in house.

**Stands:** 100—Black Music Stands

**Music Stand Lights:** 36 available

**Piano Stand Lights:** 2 available

**Orchestra Chairs:** 78 available

**Cello Chairs:** 12 available

**Podiums:** 1 Step and 2 Step available

**Instruments:** Yamaha Stage Custom Advantage Split Lugs 5-Piece Drum Set

**Amplifiers:** 2-Fender '65 Twin Reverb Guitar Amplifier  
SWR Workingman's 4004, 4 x 10T & 1 x 15T Package Amplifier



## **Risers**

**Wenger Risers 4' \* 8':**      12—8" Height  
   24—16" Height  
   12—24" Height

**Wenger Versalites 4' \* 8':**      24 available

Possible Deck Elevations: 8—8" Height  
   8—16" Height  
   8—24" Height  
   8—32" Height  
   8—40" Height  
   4—48" Height  
   6—24"-40" Height (telescoping legs)  
   36—8' braces

**Corner Pieces:**      Triangles—6" Height  
                                 Trapezoids—16" Height  
                                 Pentagons—24" Height

Corner pieces can be used to assemble semi-circle seating of 125 people.

## **Marley Dance Floor**

The Marley dance floor is reversible with black on one side and gray on the other. Each floor section is 5'3" wide and 60' long. No scenery may be placed on the floor without the consent of the Technical Director. The Marley Dance floor does not extend to cover the pit area.

## **Ladders**

**Fiberglass Standing Ladders:**      2—6' Height  
   2—10' Height  
   1—16' Height

**Genie Lifts:**      1—PLI24/DC 12v (Max Height 24 feet)

## **Fly System**

The fly system is a double purchase with locks and roped with  $\frac{3}{4}$  (3) strand premium manila. Battens are rigged to be loaded at 4' above the stage floor.

Grid Height—63'11"

Maximum Batten Height—61'11"

Control Rail Height—17'10"

Loading Rail Height—51'0"

Pipe Length—60'0"

Outside Pipe Diameter—0'2"

Arbor Length—10'6"

36—Moveable lines.

26—Clearable lines (maximum).

Pipes cannot be extended. When the stage wings are masked properly, the stage opening is reduced to a max. of 40'

**Act curtain, Midstage curtains, and Upstage curtains (lines 1, 17, 34 respectively) cannot be cleared.**

**Acoustical Ceiling (lines 6, 15, 24, 33) cannot be cleared.**

## **Act Curtain**

The Kirkland Fine Arts Center Act Curtain is a heavy lined rose red velour measuring 30' x 60'. The curtain can be operated manually as either a traveler from stage right to left or as a guillotine from the control rail. The act curtain is usually guillotined and doubles as a front border. Maximum traveled opening is 40'.

## **Other House Soft Goods**

All masking drapes are black IFR (Inherently Fire Retardant) poly.

Borders: 4—10' x 60'

Legs: 1 pair—10' x 30'

1 pair—16' x 30'

3 pair—17' x 30'

Travelers: 2—30' x 60' (Pleats sewn in)

Cyclorama: 1—30' x 60' (Opera Creamy White Front/Rear Projection Screen)

Scrim: 1—30' x 60' (White)

1—30' x 60' (Black)

Because of catwalks at the sides of the stage, it is easy to breast non-working lines upstage or downstage in either direction.

## Fly Line Sets

Set#	Location	Standard	Notes
	0' 0"	Proscenium Wall	
	0' 6"	Fire Wall	
<b>1.</b>	<b>1' 9"</b>	<b>Act Curtain</b>	<b>NOT CLEARABLE</b>
2.	2' 8"	First Leg	
3.	3' 7"	First Electric	48 Circuits
4.	5' 0"	Batten	
5.	5' 6"	Batten	
<b>6.</b>	<b>6' 4"</b>	<b>First Ceiling</b>	<b>NOT CLEARABLE</b>
7.	7' 0"	Batten	
8.	7' 10"	First Border	
9.	8' 6"	Second Leg	
10.	9' 6"	Second Electric	20 Circuits
11.	10' 6"	Batten	
12.	11' 6"	Batten	
13.	12' 6"	Batten	
14.	13' 0"	Batten	
<b>15.</b>	<b>14' 3"</b>	<b>Second Ceiling</b>	<b>NOT CLEARABLE</b>
16.	15' 0"	Batten	
<b>17.</b>	<b>15' 9"</b>	<b>Midstage Curtain</b>	<b>NOT CLEARABLE</b>
18.	16' 6"	Midstage Border	
19.	17' 6"	Third Leg	
20.	18' 6"	Third Electric	20 Circuits
21.	19' 6"	Batten	
22.	20' 6"	Batten	
23.	21' 6"	Batten	
<b>24.</b>	<b>22' 2"</b>	<b>Third Ceiling</b>	<b>NOT CLEARABLE</b>
25.	23' 0"	Batten	
26.	23' 6"	Batten	
27.	24' 6"	Border	
28.	25' 6"	Fourth Leg	
29.	26' 6"	Fourth Electric	20 Circuits
30.	27' 6"	Batten - Scrim	
31.	28' 6"	Fifth Electrical	16 Circuits
32.	29' 6"	Batten	
<b>33.</b>	<b>30' 1"</b>	<b>Fourth Ceiling</b>	<b>NOT CLEARABLE</b>
<b>34.</b>	<b>31' 0"</b>	<b>Upstage Curtain</b>	<b>NOT CLEARABLE</b>
35.	32' 0"	Batten	
<b>36.</b>	<b>33' 0"</b>	<b>Batten – Cyclorama</b>	<b>NOT CLEARABLE</b>

**Maximum Capacity 700 lbs. per batten**

# Lighting System





## **House Board**

The light booth is located in the back left of the auditorium.

Manufacturer: Electronic Theatre Controls, Inc. installation June 2013.

This board is an Eos Ti 3 w/10,000 control channels, 10,000 cues, and 1000 groups with touchscreen control and ETC universal fader wing 2x20.

Radio Focus Remote Unit (RFRU) located stage right.

DMX lighting control input stage right.

## **Dimmers**

ETC sensor 2.4k dimmer per circuit.

## **Circuiting**

House circuits are wired with 20 amp 2p&g Connectors.

<b>Location</b>	<b>Available Circuits</b>	<b>Circuit Numbers</b>
Front of House: First Cove	12 Circuits	193-204
Front of House: Second Cove (Note: 2nd cove is only used due to bad angles from 1 <sup>st</sup> cove)	20 Circuits	205-224
Front of House: House Right Loge	6 Circuits	257-262
Front of House: House Left Loge	6 Circuits	263-268
Stage: 1 <sup>st</sup> Electric	48 Circuits	1-48
Stage: 2 <sup>nd</sup> Electric	20 Circuits	97-116
Stage: 3 <sup>rd</sup> Electric	20 Circuits	117-136
Stage: 4 <sup>th</sup> Electric	20 Circuits	137-156
Stage: 5 <sup>th</sup> electric	16 Circuits	157-172
Side Slots: Stage Left	8 Circuits	270-277
Side Slots: Stage Right	8 Circuits	278-285
Catwalk: Stage Right	2—6 Circuit Drop Boxes; 1—4 Circuit Box	225-230; 231-236; 237-240
Catwalk: Stage Left	2—6 Circuit Drop Boxes; 1—4 Circuit Box	241-244; 245-250; 251-256
Floor Pockets: Upstage Stage Left-Right	36 Circuits Total (9 boxes across upstage wall)	49-80
Floor Pockets: Stage Left	8 Circuits	81-84; 89-92
Floor Pockets: Stage Right	8 Circuits	85-88; 93-96
House Lights	25 Circuits	289-313
Orchestra Shell	15 Circuits Total in Shell Ceiling; 8 Circuits Total Front of House	314-329; 330-337

## **Company Switch**

The company switch is located stage right, up one level. 25 foot run to stage right wing.

2—400 amp legs, 3 phase, 5 wire, 120/208v a.c., (800 amp service). CAM LOK connection.

Cold water or chassis ground.

## Lighting Equipment

<b>Lights &amp; Intelligent Attachments</b>	
S4 19 Degree	45
S4 26 Degree	50
S4 36 Degree	50
S4 50 Degree	10
S4 70 Degree	5
S4 Pars	100
4 Color Cyc Lights (Hanging)	4
4 Color Cyc Lights (Ground Row)	4
Apollo Smart Color 7.25 Gel Scrollers	12
Martin Mac 500	8
Martin Mac 600	4
<b>Pipes, Bases, Arms, &amp; Hardware</b>	
50lb Boom Bases	8
20' Boom Pipes	8
12' Boom Pipes	8
1" Pipe Sidearms	40
12' Vertical Extension Tubes	10
Floor Plates	25
Cable Troughs	25
Light Ladders	2
Scenery Bumpers	6
<b>Cables, Connectors, &amp; Circuit Boxes</b>	
Multiplex 2fers	20
Molded 2fers	36
Molded 3fers	12
Female Edison to male stage pin adaptors	10
Male Edison to female stage pin adaptors	10
50' Cables	20
25' Cables	20
20' Cables	20
15' Cables	20
10' Cables	50
5' Length Cables	50
30' Socaplex cable	2
Male socaplex breakouts	2
Female socaplex breakouts	2
Socaplex boxes	4
<b>Spotlights</b>	
Spot #1- Lycian 1275 Superstar (622hrs 1/13/14)	
Spot #2- Lycian 1275 Superstar (572hrs 1/13/14)	

# Sound System



## **Main Speakers**

### **Center Cluster:**

- 2—EAW MQ1364e
- 2—EAW MQ1366e
- 2—EAW MQTD415

### **Stereo Left & Right:**

- 2—EAW KF 695e
- 2—EAW KF 695z
- 2—Sub Meyer 650 R2

## **House Mixer**

The mix position is an “open air” console at the back of the house.

### **Yamaha CL5 Digital Board:**

- 72 Mono Channels + 8 Stereo Channels, 24 Mix Busses and 8 Matrix Buses
- Custom Fader Banks
- Editable Channel Names and Colors
- 48v Phantom power available to all channels
- Premium Rack
- Effect Rack
- Graphic EQ Rack
- 2 Track USB recording or playback
- Dugan Automatic Gain Control up to 16 Mic inputs
- 300 scenes
- 4 band parametric equalization and 2 dynamic processors on every input channel
- 16 DCA groups and 8 mute groups
- 16 User Define Keys and 4 User Define Knobs
- Dante Network to Rio 3216-D and Rio 1608-D

### **System Computing:**

- 1—Apple iMac 27” with Retina 5K Display 3.5 Quad-core Intel Core 16GB 1600MHZ DDR3 SDRAM
- 1—Apple iPad AIR 2
  - 1—Apple AirPort Time Capsule

## **Playback & Recording Equipment**

### **Equipment:**

- 1—Tascam CD-X1700 Dual CD Player
- 1—Tascam SS-CDR1 CD Recorder

## **Monitor Systems**

### **On Stage Monitor System:**

- 8—EAW SM 200 a 2-way switchable (passive/bi-amped) full range system
- 4—DBX 166XL Compressor/Limiter for the Crown Macro-tech 1202 amplifier
- 4—Crown Macro-tech 1202 amplifier for the SM 200
- 1—Hotspot monitor

The monitor rack is connected stage left.

The program monitor system can take signal from overhead microphones.



## **Paging System**

Paging into three zones can be performed from Stage Right or Stage Left. These zones are the Greenroom, the Dressing Rooms, and three front-of-house booths. The volume controls are defeated during paging to assure an intelligible page. A page may be made from the recording booth or box office to the Greenroom, Dressing Rooms, front-of-house booths, or Lobby. However, the volume controls can be defeated to those designated areas.

## **Wireless System**

Kirkland Fine Arts Center uses their own wireless communication system throughout events. It is the client's responsibility to get approval from the Kirkland Fine Arts Center Technical Director if the client would like to use their wireless system during an event. Clients also need to check with the Technical Director to find out if the client's wireless system is compatible with Kirkland Fine Art Center's system.

## **Sound Circuiting**

8 Omni inputs and 8 Omni outputs at the rear of the sound board.

1 Rio 1608-D stage box located at the FOH mix position and a Rio 3216-D located Backstage Stage Left.

## Microphones

Brand	Microphone Type	Notes	Quantity
AKG	414	Large Condenser	4
AKG	430	Small Condenser	4
AKG	451	Small Condenser	5
AKG	C418	Drum Mics	4
AKG	D112	Bass Drum Mic	1
AKG	N-62E	Phantom Power Supply	1
AKG	1000	Large Condenser	2
BB	Bachaus Berry	Piano Pickup	2
Countryman	DI Box	Type 85	5
Crown	CM31	Choral Hanging Mic	6
Crown	PCC 160	Boundary Floor Mic	5
Crown	PZM 3GPM*	Boundary Mic	2
Crown	PZM 6LPG*	Boundary Mic	1
Crown	PZM 30 RB	Boundary Mic	2
Crown	PX18	Phantom Power Supply	3
Helpinstill	Piano Mic	Piano Pickup	2
Sennheiser	421	Large Condenser	2
Shure	Beta 57	Dynamic	1
Shure	SM57	Dynamic	10
Shure	Beta 58	Dynamic	10
Shure	SM58	Dynamic	10
Shure	SM87	Dynamic	2
Shure	Mx418 SE/C	Cardioid Condenser Lectern Mic	1
Shure	SM99SE	Condenser Lectern Mic	1
Shure	UR4D-G1	UHF-R Wireless Receivers @ FOH Rack	10
Shure	UR1-G1	UHF-R Wireless Body Pack Transmitter	10
Shure	UR2-G1	UHF-R Wireless Handheld Mic SM BETA 58	8
Countryman	E-6 Lavaliers—Nude	Omnidirectional Earset Mic	10

\* Requires Crown PX18

## Sound Accessories

### Microphone Stands and Clips:

- 20—Microphone Stands w/Circular Bases
- 20—36" Microphone Boom Arms
- 4—Tall Tripod Microphone Stands with Boom Arms
- 4—Short Tripod Microphone Stands with Boom Arms
- 8—Desktop Short Microphone Stand
- 8—Short Weighted Microphone Stand with Boom Arms

### Cables:

- 50—XLR 25'
- 25—XLR 50'
- 10—Speakon 5'
- 10—Speakon 25'
- 10—Speakon 50'
- 5—Speakon 75'
- 5—Speakon 100'
- 5—Speakon Adapters
- 3—100' 8 Channel XLR Snake
- 1—50' 8 Channel XLR Snake
- A good supply of cable extensions and adapters is also available

## **Theatre Communications**

A Clear-Com single channel system is wired to all technical areas of the theatre.

### **Clear-Coms:**

- 1—Clear Com FreeSpeak II 1.9 GHz 2 channel
- 1— HME Pro 850 2 channel Base station
- 4— HME Pro 850 2 channel Wireless Transmitter Packs
- 18-Clear Com Packs
- 1—Clear Com Portable Speaker Box (at Light Board)
- 20-Single Muff Headsets
- 10-XLR Cable (yellow, for Clear Com use only)

## **Supplemental P.A.**

Placement of house mix desk is in the “open air” booth at the back of the orchestra seating (200’ snake run from backstage).

**Local fire codes prohibit placement of equipment in the aisles. Microphone snakes must be run up the center of the seating and secured.**

Upon *prior* approval by the Kirkland Fine Arts Center Technical Director, seats may be reserved for the placement of any additional sound equipment used for touring shows. **Reserved seats CANNOT be removed!**

The seats that may be reserved are:

Row 27—Seats L17-L24

Row 28—Seats L12-L24

Row 29—Seats L30-L35

Wenger 4’ x 8’ Versalite risers with telescoping legs will be set-up as a table upon request.

## **Company Switch**

Company Switch is located in the Stage Left wing.

- 1—200 AMP 3 Phase 5 Wire, 120/208v a.c. CAM LOK Connection w/ Isolation Ground Transformer
- 1—100 AMP 3 Phase 5 Wire, 120/208v a.c. CAM LOK Connection w/ Isolation Ground Transformer

# Millikin University - Kirkland Fine Arts Center

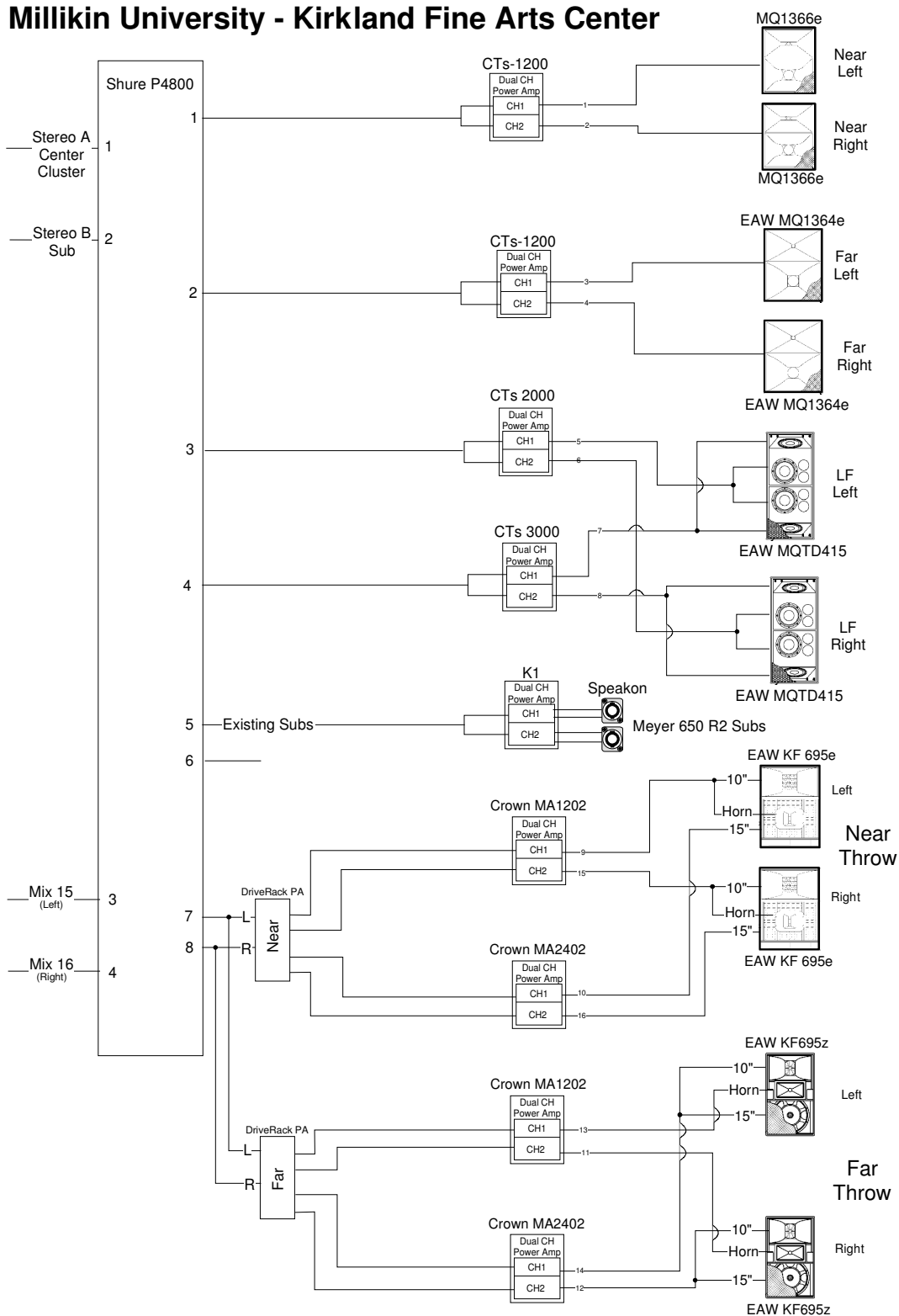

**Integrated Audio Systems, Inc.**  
 7706 N. Crestline Dr. • Peoria, Illinois 61615-1907  
 Phone: 309-693-1916 Fax: 309-693-2507

Job Name: Millikin University - Kirkland Fine Arts Center Date: 01/31/06

SM: KJ PM: DM: RB Rev As Built 04/21/06 05/15/06



# General Auditorium Information

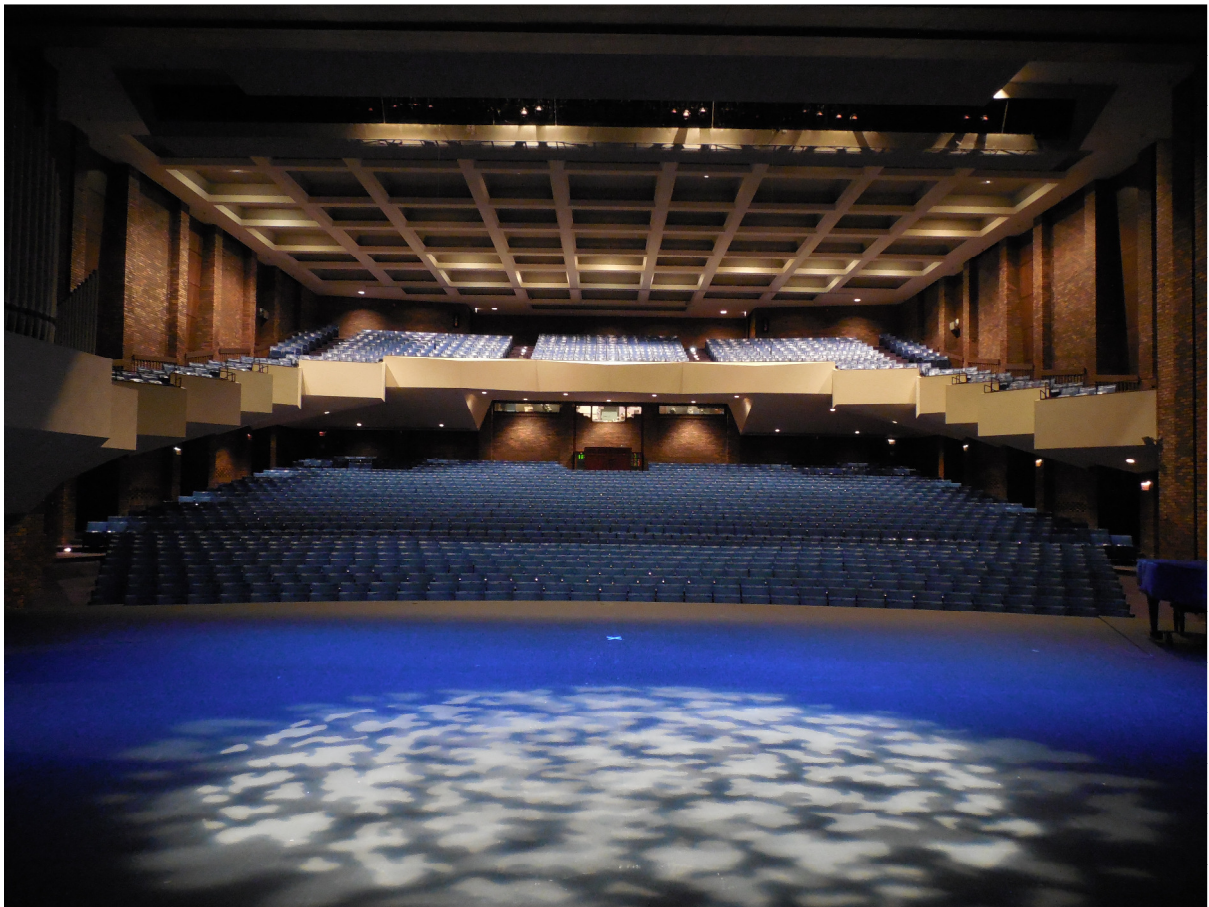

# Auditorium Seating Plan

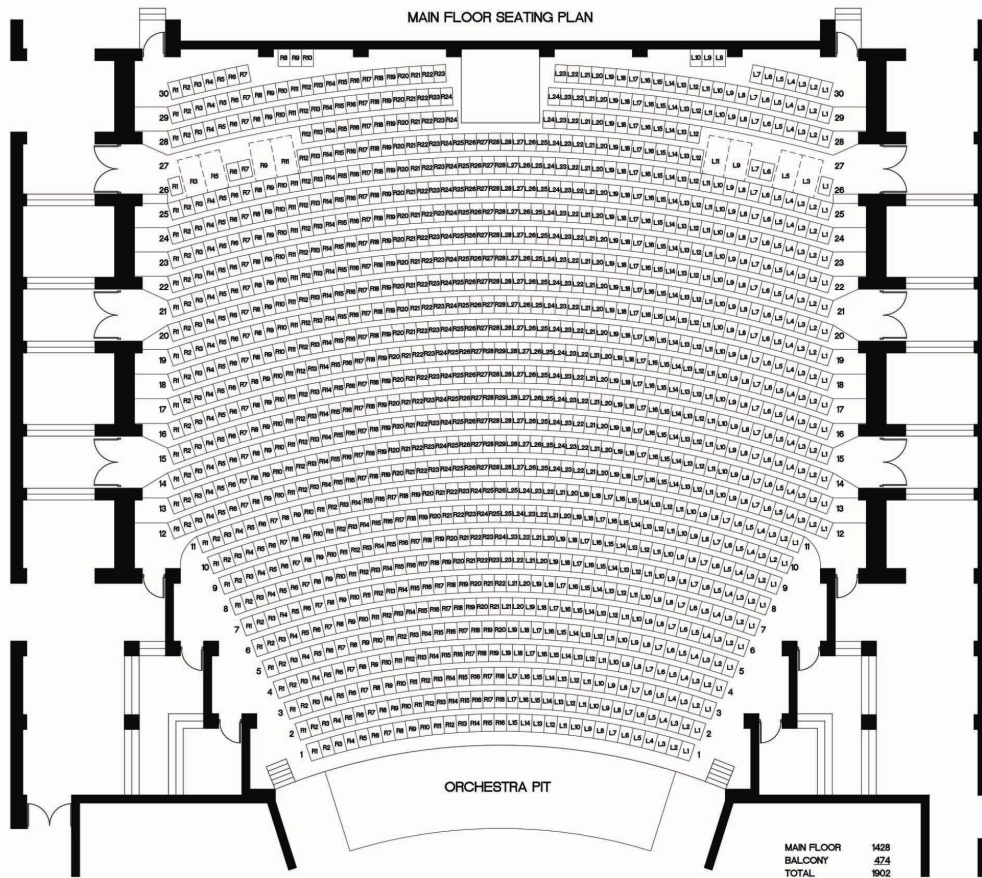
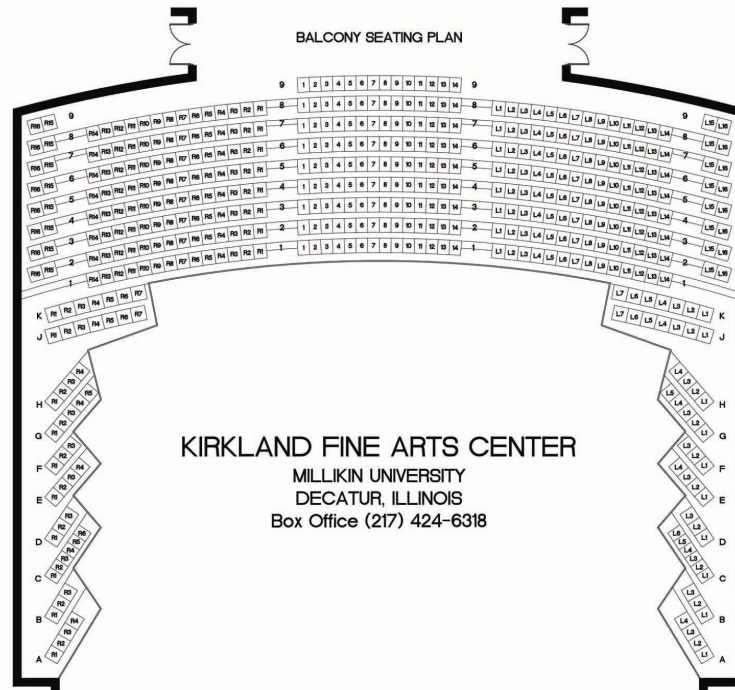

# Kirkland Main Level Ground Plan

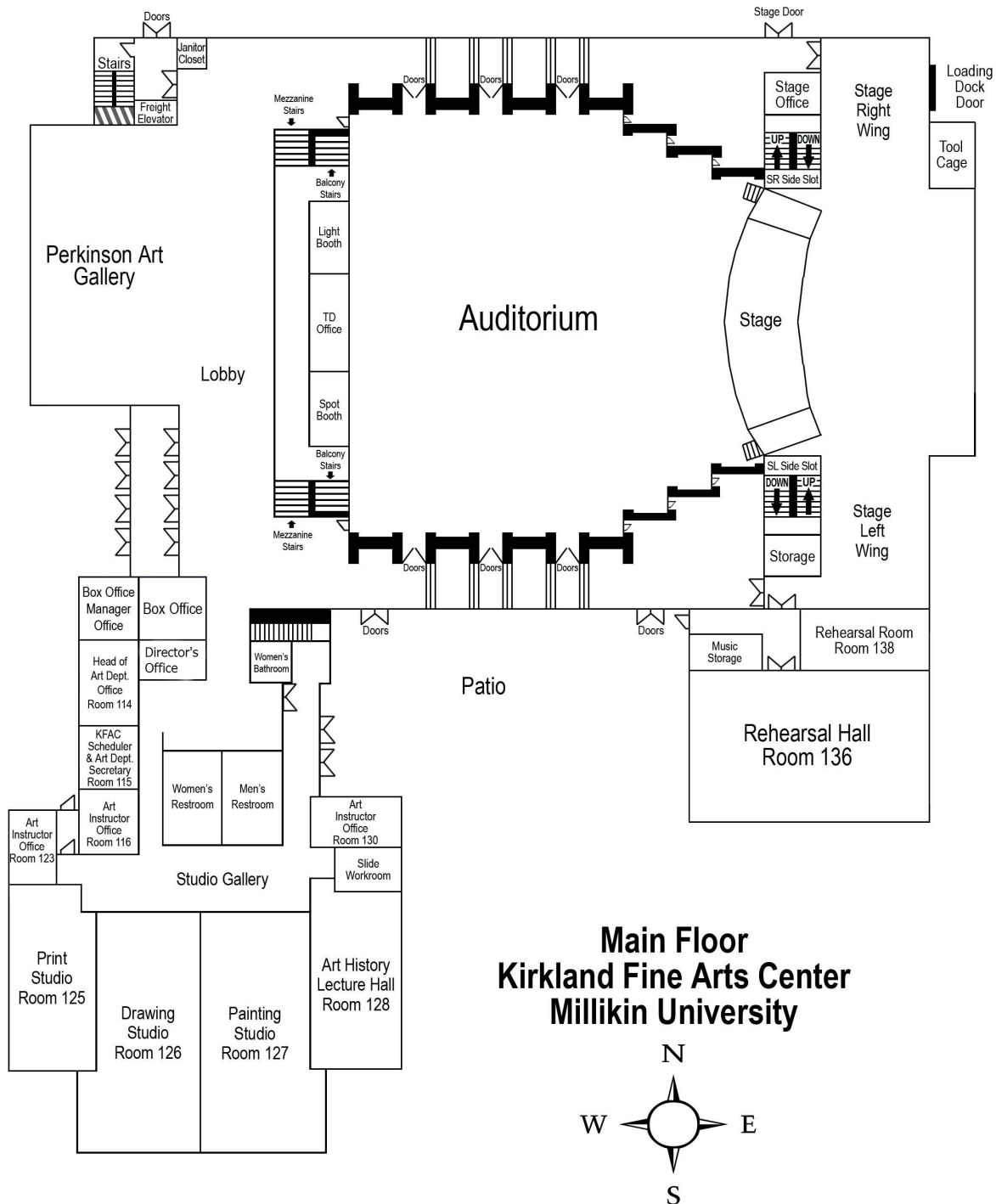

## Kirkland Lower Level Ground Plan

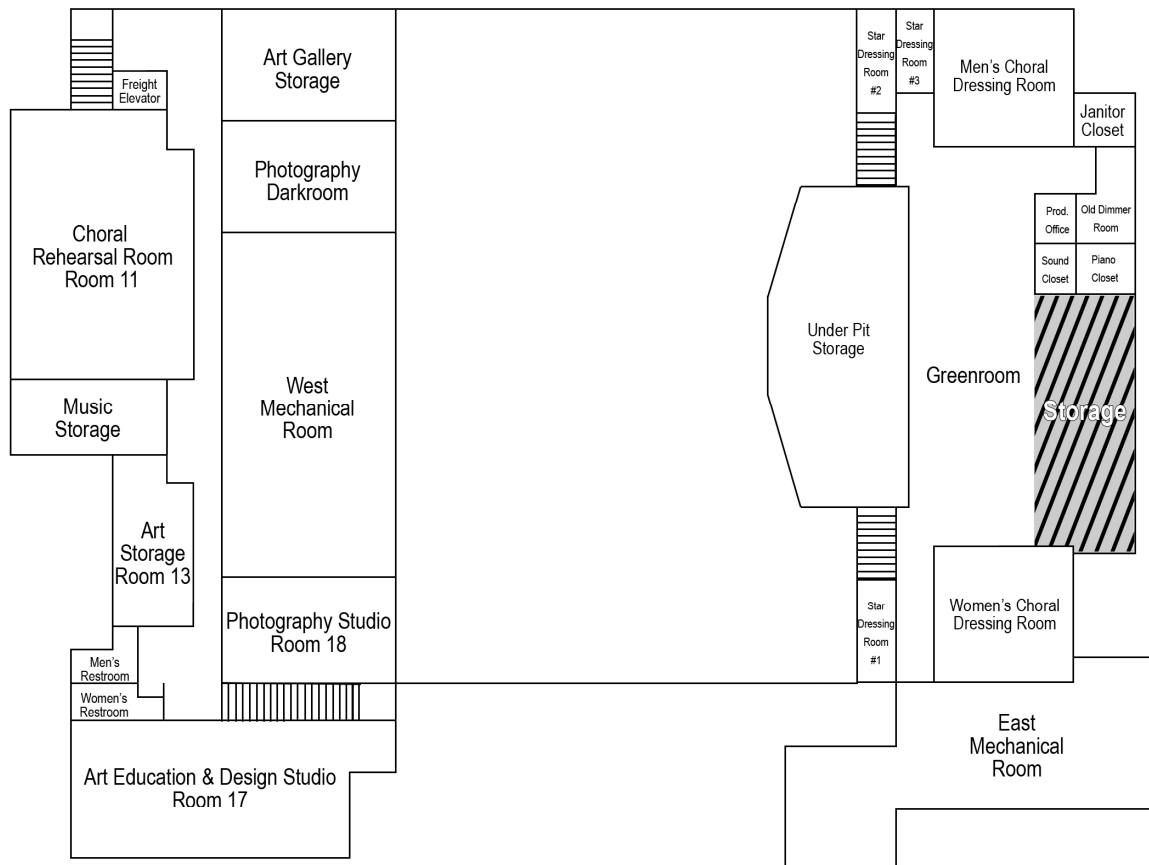

## Lower Level Kirkland Fine Arts Center Millikin University

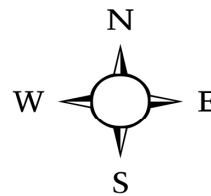

# **Dressing Rooms, Green Room, and Backstage Visitor's Information**

## **Use of Spaces:**

All Dressing Rooms and the Green Room are located one level below the stage with accessibility via stairwells on stage right and stage left. Wardrobe can be taken to the dressing rooms on the hydraulic pit lift. There are no stage-level facilities available.

### **Rooms Available:**

- 2—Large Choral dressing rooms (1—men's, 1—women's). Approximately 27' x 24' each
- 3—Private dressing rooms (2 people each). Two are located across from the men's choral dressing room and one across from the women's choral dressing room.
- 1—Large Green Room separating the men's choral dressing room from the women's choral dressing room
- 1—Production Office. Approximately 6' \* 16' with 3 chairs, a phone and Internet jack, and a fax line.

### **Dressing Rooms:**

Men's choral dressing room has 10 mirrors plus 1 full-length mirror

Women's choral dressing room has 9 mirrors plus 1 full-length mirror

Private dressing rooms have 2 mirrors plus 1 full-length each

### **Green Room:**

Several sofas and armchairs are located in the Green Room area along with dining tables and chairs.

A drinking fountain is also located in the Green Room area.

The janitor's sink, located just off of the Green Room, is available for use *upon request*.

A washer and dryer are located just off of the Green Room area and may be used *upon request*.

**Millikin University campus policy prohibits smoking, drinking, and eating in the building. With prior approval, the Green Room may be used for hospitality items only.**

### **Phone Access:**

There is one phone jack in Star Dressing Room #1 (217) 424-3938

There are two phone jacks in Star Dressing Room #2 (217) 424-3939

(217) 420-6630

There are two phone jacks in the Production Office (217) 424-3939

(217) 420-6630

Wireless Internet is available in all dressing rooms and green room.

## **Campus Security:**

Kirkland Fine Arts Center needs **4 weeks** notice prior to an event if any special security is needed at the doors or dressing rooms.

**Campus Security emergency phone number is (217) 464-8888 or \*6388**

## **Special Effects:**

Kirkland Fine Arts Center needs **4 weeks** advance notification for approval of these special effects: haze, fire, guns, special rigging and strobe. Proof of certification is required, in advance, per special field. An announcement will be made prior to the performance to alert the audience of special effects used, i.e. strobe, guns.

Campus Security will contact the Decatur Fire Marshall and make arrangements to observe the effects during load-in.

**The use of pyrotechnic devices and/or open flame sources is forbidden without prior consent from Kirkland Fine Arts Center.**



## **Theatrical Suppliers**

### **Designlab Chicago**

328 North Albany Avenue  
Chicago, IL 60612  
[www.designlab-chicago.com](http://www.designlab-chicago.com)  
Tel (773) 265-1100  
Fax (773) 265-0800

### **Brent Theatrical Lighting**

2905 Eagle Ridge Court  
Springfield, IL 62711  
Tel (217) 546-9608  
Fax (217) 546-4363

### **Prosource**

1007 North Cunningham Avenue  
Urbana, IL 61802  
Tel (217) 328-2656  
Fax (217) 328-2659

### **Knox-Array Event Production**

1305 North McKinley Avenue  
Champaign, IL 61821  
Tel (217) 355-3700

## **Medical Emergency Contact Information**

### **Dial 911**

Millikin University Campus Security: (217) 464-8888

#### **Hospitals:**

##### **Decatur Memorial Hospital**

Emergency Care Center

2300 N. Edward Street

Decatur, IL 62526

[www.dmhcares.com](http://www.dmhcares.com)

**(217) 876-8121**

##### **St. Mary's Hospital**

Emergency Department

1800 E. Lake Shore Drive

Decatur, IL 62521

[www.stmarys-hospital.com](http://www.stmarys-hospital.com)

**(217) 464-2966**

#### **Clinics:**

##### **Community Health Improvement Center**

2905 N. Main Street

Decatur, IL 62521

**(217) 877-9117**

##### **Family Medical Care of Decatur**

1770 E. Lake Shore Drive

Decatur, IL 62521

**(217) 428-3424**

##### **SIU Family Physicians**

250 W. Kenwood Avenue

Decatur, IL 62526

**(217) 872-3800**

# Traveling Information





## Map—Illinois Reference



## Map—Champaign/Urbana to Decatur



## Map—Springfield to Decatur





## Map—Bloomington to Decatur



## Transportation

### **Airports:**

- Decatur Airport (217) 428-2423
- Chicago O'Hare Airport
- Chicago Midway Airport
- St. Louis Lambert Airport (314) 426-8000
- U of I Willard Airport (217) 244-8618

### **Ground Transportation:**

- Avis Rent-A-Car (217) 422-4337
- Baldwin Shuttle Service (217) 422-5906
- Aoktni Taxi (217) 330-7771
- Enterprise Rent-A-Car (217) 875-4900
- Greyhound Bus Lines (217) 877-6262

## Map—Decatur Area

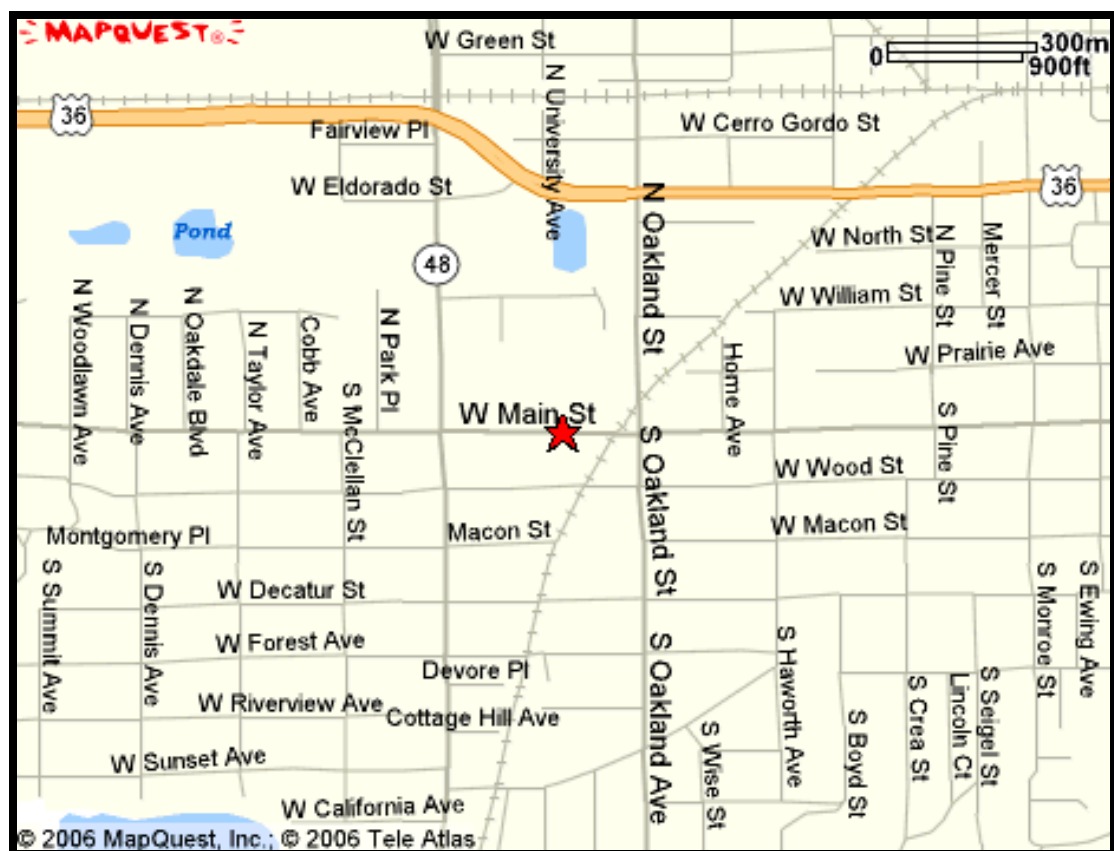

# MILLIKIN UNIVERSITY. Campus Map

## Academic Buildings / Administration

- 1 ADM-Sovell Hall
- 2 Miller School of Business, Center for Entrepreneurship, 2000E
- 3 Alumni/Development Center
- 4 Giffin Hall  
Admission Office, Registrar
- 5 Grinnell Physical Education Center
- 6 Leighty-Tabor Science Center
- 7 Dobson Hall  
Office of Residence Life
- 8 Pilling Chapel
- 9 Perkins Music Center
- 10 Shilling Hall
- 11 The Hub (Business Incubator)
- 12 RTUC (Richard T. Underhill University Center)  
Big Blue Bears Center for International Education, Center for  
Big Blue Bears Center for International Education, Office of Student Programs,  
WMA, 1001 N.W. 10th Street, Gainesville, FL 32601
- 13 Staley Library
- 14 Wellness Center

## Facilities / Operations

- 14 Power Plant
- 15 Safety & Security - Miller Hall
- 15 Star Hall Maint. Bldg. - Central Heating

## Athletics

- 16 Bartlett Tennis Courts
- 17 Decatur Indoor Sports Center (ISC)
- 18 Frank M. Lindsey Track & Field
- 19 Grinnell Physical Education Center
- 19 Practice Fields
- 20 Soccer Fields

## Fine & Performing Arts

- 21 Albert Taylor Theater
- 22 3D Art & Theatre Center
- 23 Birkle Museum - Upper Campus Hall
- 24 Kirkland Fine Arts Center
- 25 Percussion House
- 26 Perkins Music Center
- 27 Pilling Chapel
- 28 Piper Dreams Studio Theater
- 29 The Old Gym
- 30 The SPEC

## Dining

- 11 Big Blue Bistro - RTUC (Lower Level)
- 11 Warrick Dining Room - RTUC (Upper Level)
- 12 Cafe de Certe - ADM-Sovell Hall
- 27 Domino's, Subway, University Dogs
- 9 Enright Bros Bagels - (College Hall North Entrance)
- 28 Jimmy John's

## Housing

- 29 Alpha Chi Omega
- 30 Alpha Tau Omega
- 31 Aton Hall
- 32 Blackburn Hall
- 33 Delta Delta Delta
- 34 Dobson Hall
- 35 Hessler Hall
- 36 House House
- 37 Milliken East & West Apts.
- 38 Mills Hall
- 39 New Hall #2
- 40 New Hall #3
- 41 New Hall #4
- 42 Pi Beta Phi
- 43 Sigma Alpha Epsilon
- 44 Tau Kappa Epsilon
- 45 Walker Hall
- 46 Wick Hall
- 47 The Woods at Milliken Apts.

## Parking Guide

- A Faculty/Staff Parking (9:00am - 5:00pm M-F)  
Reserving from 6:00 - 7:00pm without special permission
- F Underclass Residential (permission required)
- G Greek Restricted Parking (permission required)
- W Woods Residential Parking Only
- C Designated Commuter Parking
- R Residential Parking
- V Visitor Parking

## Map—Millikin University



## **Decatur Area Lodging Information**

### **North Decatur/Forsyth:**

#### **Baymont Inn**

5100 Hickory Point Frontage Road  
Decatur, IL 62526  
(217) 875-5800

#### **Country Inns & Suites**

5150 Hickory Point Frontage Road  
Decatur, IL 62526  
(217) 872-2402  
Forsyth, IL 62535

#### **Fairfield Inn**

1417 Hickory Point Drive  
Forsyth, IL 62535  
(217) 875-3337

#### **Hampton Inn**

1429 Hickory Point Drive  
Forsyth, IL 62535  
(217) 877-5577

#### **Quality Inn**

134 Barnett Avenue  
Forsyth, IL 62535  
(217) 875-1166

#### **Ramada Limited**

355 E. Hickory Point Road  
Decatur, IL 62526  
(217) 876-8011

#### **Red Carpet Inn**

3035 North Water Street.  
Decatur, IL 62526  
(217) 877-3380

### **Northeast Decatur:**

#### **Sleep Inn**

3920 E. Hospitality Lane  
Decatur, IL 62521  
(217) 872-7700

### **Southeast Decatur:**

#### **Hawthorn Suites**

2370 South Mt. Zion Rd.  
Decatur, IL 62521  
(217) 864-9311

### **West Decatur:**

#### **Days Inn**

333 North Wyckles Road  
Decatur, IL 62522  
(217) 422-5900

#### **Decatur Conference Center & Hotel**

4191 U.S. Rt. 36 West & North Wyckles Rd.  
Decatur, IL 62522  
(217) 422-8800

## **Decatur Area Dining Information**

### **Near Millikin University:**

<b>Cherry Berry</b> 130 S. Oakland St. (217) 330-8573	\$	Sun-Thurs 11:00am-10:00pm Fri-Sat 11:00am-11:00pm
<b>Domino's</b> 1135 West Wood Street (217) 422-2244	\$	Sun-Thurs 10:30am-1:00am Fri-Sat 10:30am-3am
<b>Donnie's Homespun</b> 126 S. Oakland Ave. (217) 424-4344	\$\$	Mon-Tues, Thurs 11:00am-10:00pm Wed, Fri-Sat 11:00am-2:00am Sun 11:00am-9:00pm
<b>First Wok</b> 1683 West King St (217) 423-2900	\$\$	Mon-Thurs 11:00am-10:30pm Fri-Sat 11:00am- 11:00pm Sun 12:00pm-10:00pm
<b>Garcia's Pizza</b> 1099 West Main Street (217) 424-1800	\$	Sun-Thurs 10:00am-10:00pm Fri-Sat 10:00am-10:00pm
<b>Garden Family Restaurant</b> 696 E. Pershing Rd. (217) 872-7227	\$	Sun-Sat 6:00am-9:00pm
<b>Hardee's</b> 1080 West Eldorado Street (217) 428-6100	\$	Sun-Sat Open 24 Hours
<b>Lock Stock &amp; Barrel</b> 129 South Oakland St. (217) 429-7411	\$\$	Mon-Wed 11:00am-1:00am Thurs-Sat 11:00am-2:00am Sun closed
<b>McDonald's</b> 1835 East Eldorado Street (217) 423-1775	\$	Sun-Sat Open 24 Hours
<b>Mi Pueblito</b> 1607 West King Street (217) 428-7610	\$\$	Sun-Thurs 11:00am-9:00pm Fri-Sat 11:00am-10:00pm
<b>Pizza Hut</b> 1671 West King Street (217) 422-2600	\$\$	Sun-Thurs 10:30am-11:00pm Fri-Sat 10:30am-12 midnight
<b>Subway</b> 1135 West Wood Street (217) 422-2036	\$	Mon-Fri 7:00am-10:00pm Sat 8:00am-10:00pm Sun 9:00am-10:00pm



<b>University Dogs</b> 1105 West Wood Street (217) 422-2288	\$	Mon-Sat 10:30am-9:00 pm Sun closed Fri-Sat 11:00pm-3:00am (when MU is in session)
---	----	---

<b>Wing Stop</b> 1491 West King Street (217) 424-9464	\$	Sun-Sat 11:00am-12:00 midnight
---	----	--------------------------------

### **Downtown Decatur:**

<b>The Beach House</b> 2301 East Lakeshore Drive (217) 422-7202	\$\$	Mon-Thurs 11:00am-2:00pm/5:00pm-9:00pm Fri-Sat 11:00am-2:00pm/5:00pm-9:30pm Sun 11:00am-7:00pm
---	------	--

<b>BIZOU</b> 259 North Main Street (217) 422-7000	\$\$\$	Mon-Thurs 11:00am-2:00pm/4:00pm-9:00pm Fri 11:00-2:00pm/5:00pm-10:00pm Sat 5:00pm-9-10:00pm Sun closed
---	--------	---

<b>Downtown Café</b> 217 North Main Street (217) 428-1120	\$	Mon-Sat 6:30am-2:00pm Sun 8:00am-2:00pm
---	----	--

<b>Robbie's Grill</b> 122 N. Merchant Street (217) 423-0448	\$\$	Mon-Fri 11:00am-9:00pm Sat 12:00pm-3:00pm Sun closed
---	------	--

<b>Taproot</b> 170 N Merchant St (217) 330-6365	\$\$	Mon-Fri 11:00am-2:00pm/4:00pm-11:00pm Sat 4:00pm-11:00pm Sun closed
---	------	---

### **West Decatur:**

<b>Fireside Grill</b> 4191 US 36 West (217) 422-8810	\$\$	Mon-Sun 6:00am-2:00pm/5:00pm-9:00pm Tues-Sat 5:00pm-9:00pm
--	------	---

<b>Sport's Zone (Conference Center)</b> 4191 US 36 West (217) 422-8810	\$	Mon-Fri 4:00pm-12:00am Sat 11:00am-1:00am Sun 11:00am-12:00 midnight
--	----	--

### **North Decatur**

<b>Aloha</b> 3025 North Kandy Lane (217) 875-5540	\$\$	Sun-Thurs 11:00am-8:00pm Fri 11:00am-8:00pm Sat 3:00am-9:00pm Mon closed
---	------	---

<b>Asia House</b> 3074 North Water Street (217) 875-7900	\$\$	Mon-Thurs 11:00am-9:30pm Fri-Sat 11:00am-10:30pm Sun 12:00pm-9:00pm
--	------	---

<b>Bob Evans Restaurant</b> 3020 North Water Street (217) 875-4577	\$	Mon-Sun 6:00am-9:00pm
--	----	-----------------------

<b>Culver's</b> 2994 North Water Street (217) 875-2900	\$	Sun-Sat 10:30am-10:00pm
<b>Dairy Queen</b> 610 Snyder Street (217) 877-4131	\$	Mon-Sun 5:30am-11:00pm
<b>IHOP</b> 1280 East Pershing Road (217) 877-4467	\$	Sun-Thurs 6:00am-12:00 midnight Fri-Sat Open 24 Hours
<b>KFC</b> 1310 East Pershing Road (217) 872-1725	\$	Sun- Sat 10:30am-10:00pm
<b>La Gondola</b> 2034 South Mt. Zion Road (217) 864-4333	\$	Tues-Sat 11:00am-9:00pm Sun-Mon closed
<b>McDonald's</b> 3005 North Water Street (217) 877-9259	\$	Sun-Sat Open 24 Hours
<b>Olive Garden</b> 3795 US Rt 51 North (217) 877-7470	\$\$	Sun-Thurs 11:00am-10:00pm Fri-Sat 11:00am-11:00pm
<b>Panera Bread</b> 255 East Ash Avenue (217) 872-6435	\$	Mon-Sat 5:30am-9:00pm Sun 7:00am-9:00pm
<b>Perkins Restaurant</b> 2999 North Monroe Street (217) 875-0743	\$\$	Sun-Thur 6:00am-12:00 midnight Fri-Sat 24 Hours
<b>Popeye's</b> 775 East Pershing Road (217) 330-6126	\$	Sun-Sat 10:00am-10:00pm
<b>Steak-n-Shake</b> 1330 East Pershing Road (217) 877-3231	\$	Sun-Sat Open 24 Hours
<b>Taco Bell</b> 753 East Pershing Road (217) 875-0155	\$	Sun-Thurs 11:00am-10:0pm Fri-Sat 11:00am- 11:00pm
<b>Wendy's</b> 102 West Pershing Road (217) 872-6442	\$	Sun-Sat 10:00am-1:00am

## **Forsyth**

<b>Applebee's Grill &amp; Bar</b> 1275 South Route 51 (217) 875-0281	\$\$	Sun-Thurs 11:00am-12:00 midnight Fri-Sat 11:00am-1:00am
<b>Buffalo Wild Wings</b> 851 South US Rt 51 (217) 877-8370	\$	Sun-Thurs 11:00am-12:00 midnight Fri-Sat 11:00am-1:00am
<b>Cheddar's Casual Café</b> 1340 Hickory Point Drive (217) 877-3100	\$	Sun-Thurs 11:00am-10:00pm Fri-Sat 11:00am-11:00pm
<b>O'Charley's</b> 927 Hwy 51 (217) 872-1672	\$\$	Sun 10:00am-10:00pm Mon-Thurs 11:00am-10:00pm Fri-Sat 11:00am-11:00pm
<b>Panda Express</b> Hickory Point Mall (217) 875-5912	\$	Mon-Sat 10:30am-9:00pm Sun 12:00 noon-5:00pm
<b>Red Lobster</b> 997 South Route 51 (217) 875-3196	\$\$	Mon-Thurs 11:00am-9:00pm Fri-Sun 11:00am-10:00pm
<b>Steak 'n Shake</b> 920 South Main, Rt 51 (217) 876-0107	\$	Mon-Sun 24 hours a day
<b>Subway</b> Hickory Point Mall (217) 872-1121	\$	Mon-Sat 10:00am-9:00pm Sun 12:00 noon-5:00pm
<b>Texas Roadhouse</b> 1155 North Route 51 (217) 876-7380	\$\$	Mon-Thurs. 4:00pm-10:00pm Fri 4:00pm-11:00pm Sat. 11:00am-11:00pm Sun. 11:00am-10:00pm

\$	\$5.00-\$10.00
\$\$	\$10.00-\$20.00
\$\$\$	\$20.00-\$30.00
\$\$\$\$	\$30.00-\$40.00